



### **Licensing Sub-Committee Tuesday, 17th September, 2019**

You are invited to attend the next meeting of **Licensing Sub-Committee**, which will be held at:

**Council Chamber, Civic Offices, High Street, Epping  
on Tuesday, 17th September, 2019  
at 10.00 am .**

**Georgina Blakemore  
Chief Executive**

**Democratic Services  
Officer**

S. Tautz (01992) 564243))  
Email: [democraticservices@eppingforestdc.gov.uk](mailto:democraticservices@eppingforestdc.gov.uk)

#### **Members:**

Councillors R Morgan (Chairman), J Jennings, P Stalker, D Stocker

**PLEASE NOTE THE TIME OF THIS MEETING**

- 1. APOLOGIES FOR ABSENCE**
- 2. DECLARATIONS OF INTEREST**  
To declare interests in any item on this agenda.
- 3. PROCEDURE FOR THE CONDUCT OF BUSINESS (Pages 3 - 8)**  
To note the adopted procedure for the conduct of business by the Sub-Committee.
- 4. APPLICATION FOR PREMISES LICENCE - HARLEY'S BISTRO & LOUNGE, 184 HIGH STREET, EPPING (Pages 9 - 38)**  
To consider the attached report.
- 5. APPLICATION FOR VARIATION OF PREMISES LICENCE - EFEZADE, 12-14 THE BROADWAY, LOUGHTON (Pages 39 - 102)**  
To consider the attached report.
- 6. APPLICATION FOR PREMISES LICENCE - HARLOW GARDEN CENTRE, CANES LANE, HASTINGWOOD (Pages 103 - 130)**

To consider the attached report.

## 7. EXCLUSION OF PUBLIC AND PRESS

**Exclusion:** To consider whether, under Section 100(A)(4) of the Local Government Act 1972, the public and press should be excluded from the meeting for the items of business set out below on grounds that they will involve the likely disclosure of exempt information as defined in the following paragraph(s) of Part 1 of Schedule 12A of the Act (as amended) or are confidential under Section 100(A)(2):

Agenda Item No	Subject	Exempt Information Paragraph Number
Nil	Nil	Nil

The Local Government (Access to Information) (Variation) Order 2006, which came into effect on 1 March 2006, requires the Council to consider whether maintaining the exemption listed above outweighs the potential public interest in disclosing the information. Any member who considers that this test should be applied to any currently exempted matter on this agenda should contact the proper officer at least 24 hours prior to the meeting.

**Background Papers:** Article 17 - Access to Information, Procedure Rules of the Constitution define background papers as being documents relating to the subject matter of the report which in the Proper Officer's opinion:

- (a) disclose any facts or matters on which the report or an important part of the report is based; and
- (b) have been relied on to a material extent in preparing the report and does not include published works or those which disclose exempt or confidential information and in respect of executive reports, the advice of any political advisor.

The Council will make available for public inspection for four years after the date of the meeting one copy of each of the documents on the list of background papers.

## Licensing Committee - Terms of Reference

- (1) The full Committee shall comprise 15 Councillors appointed by the Council at its annual meeting, including a Chairman and Vice-Chairman.
- (2) For the functions set out in Appendix 1, and the legislation listed in Appendix 2, a sub-committee consisting of no more than any three Councillors drawn from the members of the full Committee shall be formed. Any such sub-committee shall include, by rota, one of the six Licensing Sub-Committee Chairmen appointed at each Annual Council meeting.
- (3) The Quorum for the Committee is set out in the Rules set out in Part 4 of this Constitution save that no business shall be transacted unless either the Chairman or Vice-Chairman of the Committee is present.
- (4) The Committee and sub-committees shall have full authority to hear and determine licensing applications.
- (5) The Committee and sub-committees shall be further empowered to determine appeals made against the decisions of the Service Director (Commercial and Regulatory Services) taken under delegated authority on licensing applications. (See Council delegation schedule for more details)
- (6) The Committee shall at all times carry out its duties solely within the policy from time to time determined by the Council and shall conduct its proceedings in accordance with the requirements set out in Appendix 3 (Conduct of Business by Licensing Committee and Sub-Committees).
- (7) The Licensing Committee shall take no part in the production or revision of the statement of licensing policy made under Section 5 of the Licensing Act 2003, however, they may determine policy under the legislation listed in Appendix 2 to this Article.
- (8) To be responsible for the consideration and approval of Designation Orders under Section 13 of the Criminal Justice and Police Act 2001 (Exercise of Controls over the consumption of alcohol in Public Places).

**LICENSING ACT 2003 – LIST OF FUNCTIONS AND DELEGATED AUTHORITY**

<b>Matter to be dealt with</b>	<b>Full Committee</b>	<b>Sub-Committee</b>	<b>Officers</b>
Application for personal licence		If a police objection	If no objection made
Application for personal licence with unspent convictions		All cases	
Application for premises licence/club premises certificate		If a relevant representation made	If no relevant representation made
Application for provisional statement		If a relevant representation made	If no relevant representation made
Application to vary premises licence/club premises certificate		If a relevant representation made	If no relevant representation made
Application to vary designated premises supervisor		If a police objection	All other cases
Request to be removed as designated premises supervisor			All cases
Application for transfer of premises licence		If a police objection	All other cases
Applications for interim Authorities		If a police objection	All other cases
Application to review premises licence/club premises certificate		All cases	
Decision on whether a complaint is irrelevant frivolous vexatious etc			All cases
Decision to object when local authority is a consultee and not the relevant authority considering the application		All cases	
Determination of a police objection to a temporary event notice		All cases	
All policy matters except the formulation of the statement of licensing policy	All cases		

**LIST OF STATUTORY POWERS**

Those functions pertaining to licensing and registration and permits and consents contained in the following legislation and any regulations, orders, byelaws or other subsidiary legislation made under the above Acts:

Animal Boarding Establishments Act 1963  
Breeding & Sale of Dogs (Welfare) Act 1999  
Breeding of Dogs Act 1973  
Breeding of Dogs Act 1991  
Caravan Sites & Control of Development Act 1960  
Caravan Sites Act 1968  
Dangerous Wild Animals Act 1976  
Gambling Act 2005  
Guard Dogs Act 1975  
House to House Collections Act 1939  
Licensing Act 2003  
Local Government (Miscellaneous Provisions) Act 1976  
Local Government (Miscellaneous Provisions) Act 1982  
Pet Animals Act 1951  
Pet Animals Act 1951 (Amendment) Act 1983  
Riding Establishments Acts 1964 & 1970  
Scrap Metal Dealers Act 1964  
Scrap Metal Dealers Act 2013  
The Game Act 1831  
Town Police Clauses Act 1847  
Town Police Clauses Act 1889  
Zoo Licensing Act 1981

**PART A – CONDUCT OF BUSINESS BY LICENSING COMMITTEE AND SUB-COMMITTEES**

All references to committee in this annex shall be taken to infer a reference to the associated subcommittees.

**1. General Conduct**

- 1.1 All hearings of the Licensing Committee under the Licensing Act 2003, are to be held in accordance with the Personal Licences, Hearings, Premises Licences and Club Premises Certificates, and Licensing Register Regulations, made under the Licensing Act 2003.
- 1.2 The Council's Constitution shall regulate the conduct of and debate at meetings.
- 1.3 In the case of hearings under the Licensing Act 2003, the Committee shall only consider those matters relevant to the licensing objectives as set out in the Licensing Act 2003 and the statement of licensing policy adopted by the Council.

**2. Declarations of Interest**

- 2.1 Members of the Committee are subject to the Council's Code of Conduct.

**3. Participation in the Hearing**

- 3.1 Debate shall be restricted to members of the Licensing Committee. Where a local ward member, not being a member of the Committee, wishes to participate in the hearing, they may do so only with the permission of the Chairman and their participation shall be subject to the same rules as are applied to any other witnesses to the application.
- 3.2 In hearings other than those under the Licensing Act 2003, where a ward member is a member of the Committee, and wishes to object to the application, the member shall give 14 days' notice of their intention, and shall play no part in the decision-making process of the Committee. In hearings under the Licensing Act 2003, those named as responsible authorities and interested parties in the Act may only make representations within the time limits set out in the relevant statutory provisions.
- 3.3 All persons participating in the hearing shall be made aware of the limitations or scope of statements that will be acceptable and, in particular, that statements should be factual or a fair statement on a matter of public interest.
- 3.4 In the case of any hearing pursuant to the summary review procedure under the Violent Crime Reduction Act 2006, the membership of any Subcommittee adjudicating on such a review shall comprise any three members drawn from the Licensing Committee subject to the proviso that no member should serve more than one hearing.

#### **4. Attendance of the Public**

- 4.1 The Council's Constitution and relevant statutory provisions relating to the admission or exclusion of the public shall apply to all meetings of the Licensing Committee.

#### **5. Natural Justice**

- 5.1 There are two elements to natural justice:

##### **(a) Fairness**

- (i) All persons affected by the decision or in the case of matters associated with the Licensing Act 2003, those named as responsible authorities and interested parties in the Act, will be allowed a hearing before a decision is made.
- (ii) Only objectors who can show clearly that they are affected by a decision shall be afforded the right to be heard or, in the case of hearings under the Licensing Act 2003, only those named in the Act as responsible authorities or interested parties.
- (iii) All information shall be made available, where possible in advance, to the applicant and the Committee.
- (iv) All members of the Committee shall be present throughout the hearing of a particular application. Where a member arrives late or leaves during a hearing of a particular application, that member shall play no part in the decision-making process. Where an application is adjourned it shall be continued by the same members only, and no others.
- (v) The Committee shall have discretion in respect of 'late' objections. Such objections shall be clearly marked on the agenda as such and the Committee shall decide on their acceptability. The applicant shall be advised of any late objections. In the case of representations made in relation to the Licensing Act 2003 applications, these shall only be accepted in accordance with the relevant statutory provisions.

##### **(b) Prevention of Bias**

- (i) The rules on the declarations of interest shall be firmly applied.
- (ii) If the Committee moves into private session to consider its decision, it shall be accompanied only by its advising officers, none of whom shall have taken a substantive part in the hearing, and shall play no substantive part in the decision-making process.

#### **6. General Procedures for Hearings**

- 6.1 The following procedural requirements shall be followed at all times:

- (a) There shall be no recommendation from officers on the agenda;
- (b) The Committee shall be supplied with copies of all relevant documentation and the process and order of procedure shall be as follows:

- (i) The Chairman will open the meeting and introduce persons as appropriate asking applicants and representatives to identify themselves.
- (ii) The Chairman will outline the procedure to be followed.
- (iii) The Lead Officer will outline the matter in hand.
- (iv) The applicant or representative will present his/her case, with or without witnesses, and be questioned by members or any objectors/persons making representations present.
- (v) Any objectors/persons making representations may then present their objections/representation, with or without witnesses, and be questioned by members or the applicant/s or their representative.
- (vi) The objectors/persons making representations may make a final statement (without introducing new issues).
- (vii) Finally, the applicant has the right to make a final statement (without introducing new issues).
- (viii) All evidence/disclosures are to be made in the presence of all persons, unless someone voluntarily excuses themselves from the proceedings.
- (ix) Committee members shall restrict themselves to questions and not discussion or comment.
- (x) The applicant, objectors/persons making representations shall be allowed to ask officers questions of a technical/factual nature at any time during the proceedings.
- (xi) An adjournment should be granted where to do otherwise would deny a fair hearing.
- (xii) The Committee may resolve to decide upon the application in private session, however, if it becomes necessary to recall anyone for additional information, everyone shall be invited to return to the Hearing.
- (xiii) The decision shall be given in the presence of all parties that wish to be present and confirmed in writing as soon as possible thereafter. If legal advice is given to members this advice will be repeated in summary form.



## **Report to the Licensing Sub-Committee**

**Date of meeting: 17 September 2019**



**Epping Forest  
District Council**

**Subject:** Application for Premises Licence - Harley's Bistro & Lounge, 184 High Street, Epping

**Responsible Officer:** D. Houghton (01992) 564336))

**Democratic Services Officer:** S. Tautz (01992) 564180))

---

### **Decisions Required:**

**To consider an application for a Premises Licence under the Licensing Act 2003, with regard to Harley's Bistro and Lounge, 184 High Street, Epping.**

### **Application**

1. An application has been made by Ugur Kesen of Harley's Bistro and Lounge, for a new premises licence at 184 High Street, Epping, Essex, CM16 4AQ. The application is for the following licensing activities:
  - (a) the sale by retail of alcohol on the premises only from Monday to Sunday from 10.00 to 22.30; and
  - (b) the opening times of the premises are from Monday to Sunday from 07.00 to 23.00.
2. The application was received on 16 July 2019 and is attached as an appendix to this report, together with a plan of the premises.
3. The Operating Schedule sets out conditions which will be attached to the licence if this application is granted.

### **Licensing Act 2003**

4. When considering an application for a licence, the licensing authority must have regard to steps that are appropriate to the promotion of the licensing objectives. These are:
  - (a) the prevention of crime and disorder;
  - (b) public safety;
  - (c) the prevention of public nuisance; and
  - (d) the protection of children from harm.
5. The licensing authority must also have regard to its Statement of Licensing Policy and any guidance issued by the Secretary of State.

### **Consultation**

6. The responsible authorities have all been consulted with regard to the application, which was also advertised at the premises and in a local newspaper. A copy of the public notice and newspaper publication is also attached as an appendix to this report.

7. All residences and businesses situated within a radius of 150 metres of the premises have been individually consulted on the application. The Council has received one representation from a local resident with regard to the application, which is also attached to this report. This objection to the application relates to the prevention of crime and disorder, the prevention of public nuisance, public safety and the protection of children from harm.
8. Essex Police have made no representations in respect of the application.

### **Guidance Issued by the Secretary of State**

9. The Licensing Act 2003 provides that the licensing authority must 'have regard to' guidance issued by the Secretary of State under Section 182 of the Act. Sections 2.15 to 2.21 of the Guidance are relevant to this application.

### **Options**

10. In determining the application, the Sub-Committee may take any of the following steps as it considers necessary for the promotion of the licensing objectives, namely:
  - (a) to grant the licence as applied for subject to:
    - (i) the conditions mentioned in the Operating Schedule modified as the Sub-committee considers necessary for the promotion of the licensing objectives, and
    - (ii) the mandatory conditions specified in the Licensing Act 2003, or
  - (b) to exclude from the scope of the licence any licensable activities to which the application relates, or
  - (c) to refuse to specify a person as the premises supervisor, or
  - (d) to reject the application.

### **Determination**

11. The Sub-Committee is asked to determine the application having regard to:
  - (a) the content of this report and representations;
  - (b) any additional information obtained from the hearing;
  - (c) the Council's statement of licensing policy;
  - (d) guidance issued by the Secretary of State, and
  - (e) the steps appropriate to promote the licensing objectives.

### **Appeal**

12. If any party is aggrieved with the decision of the Sub-Committee with regard to the application, they can appeal to the Magistrates Court. The appeal period is twenty-one days from the notification of the decision.

### **Background papers used in the preparation of this report:**

- the Licensing Act 2003:  
<http://www.legislation.gov.uk/ukpga/2003/17/contents?view=plain>
- the Secretary of State's Guidance issued under Section 182 of the Licensing Act 2003; and
- Epping Forest District Council's statement of licensing policy  
<http://www.eppingforestdc.gov.uk>

### **Attached documents**

- application for premises licence;
- plan of the premises;
- newspaper publication and public notice;
- copy of representation from local resident; and
- copy of representation from Essex Police.

This page is intentionally left blank

\* required information

**Section 1 of 21**

You can save the form at any time and resume it later. You do not need to be logged in when you resume.

System reference

Not Currently In Use

This is the unique reference for this application generated by the system.

Your reference

You can put what you want here to help you track applications if you make lots of them. It is passed to the authority.

Are you an agent acting on behalf of the applicant?

Yes  No

Put "no" if you are applying on your own behalf or on behalf of a business you own or work for.

**Applicant Details**

\* First name

UGUR

\* Family name

KESEN

\* E-mail

Main telephone number

Include country code.

Other telephone number

Indicate here if the applicant would prefer not to be contacted by telephone

Is the applicant:

- Applying as a business or organisation, including as a sole trader  
 Applying as an individual

A sole trader is a business owned by one person without any special legal structure. Applying as an individual means the applicant is applying so the applicant can be employed, or for some other personal reason, such as following a hobby.

Continued from previous page...

**Address**

\* Building number or name

\* Street

District

\* City or town

County or administrative area

\* Postcode

\* Country

**Agent Details**

\* First name

\* Family name

\* E-mail

Main telephone number  Include country code.

Other telephone number

Indicate here if you would prefer not to be contacted by telephone

Are you:

- An agent that is a business or organisation, including a sole trader
- A private individual acting as an agent

A sole trader is a business owned by one person without any special legal structure.

**Agent Business**

Is your business registered in the UK with Companies House?  Yes  No

Note: completing the Applicant Business section is optional in this form.

Registration number

Business name

VAT number

Legal status

Your position in the business

Home country

If your business is registered, use its registered name.

Put "none" if you are not registered for VAT.

The country where the headquarters of your business is located.

Continued from previous page...

**Agent Registered Address**

Address registered with Companies House.

Building number or name	<input type="text" value="3"/>
Street	<input type="text" value="WINDSOR CLOSE"/>
District	<input type="text" value="CHESHUNT"/>
City or town	<input type="text" value="WALTHAM CROSS"/>
County or administrative area	<input type="text" value="HERTFORDSHIRE"/>
Postcode	<input type="text" value="EN7 5LW"/>
Country	<input type="text" value="United Kingdom"/>

**Section 2 of 21**

**PREMISES DETAILS**

I/we, as named in section 1, apply for a premises licence under section 17 of the Licensing Act 2003 for the premises described in section 2 below (the premises) and I/we are making this application to you as the relevant licensing authority in accordance with section 12 of the Licensing Act 2003.

**Premises Address**

Are you able to provide a postal address, OS map reference or description of the premises?

- Address    OS map reference    Description

**Postal Address Of Premises**

Building number or name	<input type="text" value="HARLEY'S BISTRO &amp; LOUNGE, 184"/>
Street	<input type="text" value="HIGH STREET"/>
District	<input type="text"/>
City or town	<input type="text" value="EPPING"/>
County or administrative area	<input type="text" value="ESSEX"/>
Postcode	<input type="text" value="CM16 4AQ"/>
Country	<input type="text" value="United Kingdom"/>

**Further Details**

Telephone number	<input type="text"/>
Non-domestic rateable value of premises (£)	<input type="text" value="21,000"/>

**Section 3 of 21**

**APPLICATION DETAILS**

In what capacity are you applying for the premises licence?

- An individual or individuals
- A limited company / limited liability partnership
- A partnership (other than limited liability)
- An unincorporated association
- Other (for example a statutory corporation)
- A recognised club
- A charity
- The proprietor of an educational establishment
- A health service body
- A person who is registered under part 2 of the Care Standards Act 2000 (c14) in respect of an independent hospital in Wales
- A person who is registered under Chapter 2 of Part 1 of the Health and Social Care Act 2008 in respect of the carrying on of a regulated activity (within the meaning of that Part) in an independent hospital in England
- The chief officer of police of a police force in England and Wales

**Confirm The Following**

- I am carrying on or proposing to carry on a business which involves the use of the premises for licensable activities
- I am making the application pursuant to a statutory function
- I am making the application pursuant to a function discharged by virtue of Her Majesty's prerogative

**Section 4 of 21**

**INDIVIDUAL APPLICANT DETAILS**

**Applicant Name**

Is the name the same as (or similar to) the details given in section one?

- Yes                       No

If "Yes" is selected you can re-use the details from section one, or amend them as required. Select "No" to enter a completely new set of details.

First name

Family name

Is the applicant 18 years of age or older?

- Yes                       No



Continued from previous page...

### Current Residential Address

Is the address the same as (or similar to) the address given in section one?

Yes  No

If "Yes" is selected you can re-use the details from section one, or amend them as required. Select "No" to enter a completely new set of details.

Building number or name	<input type="text"/>
Street	<input type="text"/>
District	<input type="text"/>
City or town	<input type="text"/>
County or administrative area	<input type="text"/>
Postcode	<input type="text"/>
Country	<input type="text" value="United Kingdom"/>

### Applicant Contact Details

Are the contact details the same as (or similar to) those given in section one?

Yes  No

If "Yes" is selected you can re-use the details from section one, or amend them as required. Select "No" to enter a completely new set of details.

E-mail	<input type="text"/>
Telephone number	<input type="text"/>
Other telephone number	<input type="text"/>
* Date of birth	<input type="text" value="dd"/> / <input type="text" value="mm"/> / <input type="text" value="yyyy"/>
* Nationality	<input type="text" value="BRITISH"/>
Right to work share code	<input type="text"/>

Documents that demonstrate entitlement to work in the UK  
Right to work share code if not submitting scanned documents

## Section 5 of 21

### OPERATING SCHEDULE

When do you want the premises licence to start?  /  /   
dd mm yyyy

If you wish the licence to be valid only for a limited period, when do you want it to end  /  /   
dd mm yyyy

Provide a general description of the premises

Continued from previous page...

For example the type of premises, its general situation and layout and any other information which could be relevant to the licensing objectives. Where your application includes off-supplies of alcohol and you intend to provide a place for consumption of these off-supplies you must include a description of where the place will be and its proximity to the premises.

The site is occupying ground floor of the two storey building located at the busy commercial high street. The premises will be operating as a medium size bistro restaurant with around 70 seats serving international style, fresh prepared baked,grilled, fried and /or cooked hot foods and cold foods with hot and cold drinks.  
"The bar" where the alcohol "displayed" will be located at "the rear part of the restaurant seating area" as shown in the attached plan submitted. Alcohols will be "stored" in the bar area and walk-in chiller at the kitchen.  
-Cash register of the restaurant will be located at the bar behind the counter.  
-The main entrance & fire exit opening towards to the High street. There is one fire exit at the rear exiting to the rear car park leading to the Hemnall street.  
-The premises will have 1 disable and ladies shared WC and one male WC for it's customers.  
-Supply of alcohol consumption on the premises with food will take place during the permitted hours.

If 5,000 or more people are expected to attend the premises at any one time, state the number expected to attend

#### Section 6 of 21

##### PROVISION OF PLAYS

See guidance on regulated entertainment

Will you be providing plays?

Yes  No

#### Section 7 of 21

##### PROVISION OF FILMS

See guidance on regulated entertainment

Will you be providing films?

Yes  No

#### Section 8 of 21

##### PROVISION OF INDOOR SPORTING EVENTS

See guidance on regulated entertainment

Will you be providing indoor sporting events?

Yes  No

#### Section 9 of 21

##### PROVISION OF BOXING OR WRESTLING ENTERTAINMENTS

See guidance on regulated entertainment

Will you be providing boxing or wrestling entertainments?

Yes  No

#### Section 10 of 21

##### PROVISION OF LIVE MUSIC

See guidance on regulated entertainment

Will you be providing live music?

Continued from previous page...

**Section 11 of 21**

**PROVISION OF RECORDED MUSIC**

See guidance on regulated entertainment

Will you be providing recorded music?

- Yes  No

**Section 12 of 21**

**PROVISION OF PERFORMANCES OF DANCE**

See guidance on regulated entertainment

Will you be providing performances of dance?

- Yes  No

**Section 13 of 21**

**PROVISION OF ANYTHING OF A SIMILAR DESCRIPTION TO LIVE MUSIC, RECORDED MUSIC OR PERFORMANCES OF DANCE**

See guidance on regulated entertainment

Will you be providing anything similar to live music, recorded music or performances of dance?

- Yes  No

**Section 14 of 21**

**LATE NIGHT REFRESHMENT**

Will you be providing late night refreshment?

- Yes  No

**Section 15 of 21**

**SUPPLY OF ALCOHOL**

Will you be selling or supplying alcohol?

- Yes  No

**Standard Days And Timings**

**MONDAY**

Start

End

Start

End

**TUESDAY**

Start

End

Start

End

**WEDNESDAY**

Start

End

Start

End

Give timings in 24 hour clock.  
(e.g., 16:00) and only give details for the days  
of the week when you intend the premises  
to be used for the activity.

Continued from previous page...

THURSDAY

Start 10:00

End 22:30

Start

End

FRIDAY

Start 10:00

End 22:30

Start

End

SATURDAY

Start 10:00

End 22:30

Start

End

SUNDAY

Start 10:00

End 22:30

Start

End

Will the sale of alcohol be for consumption:

- On the premises     Off the premises     Both

If the sale of alcohol is for consumption on the premises select on, if the sale of alcohol is for consumption away from the premises select off. If the sale of alcohol is for consumption on the premises and away from the premises select both.

State any seasonal variations

For example (but not exclusively) where the activity will occur on additional days during the summer months.

None.

Non-standard timings. Where the premises will be used for the supply of alcohol at different times from those listed in the column on the left, list below

For example (but not exclusively), where you wish the activity to go on longer on a particular day e.g. Christmas Eve.

Including bank holidays and public holidays.

State the name and details of the individual whom you wish to specify on the licence as premises supervisor

Name

First name UGUR

Family name KESEN

Continued from previous page...

Date of birth

/  /   
dd mm yyyy

**Enter the contact's address**

Building number or name

Street

District

City or town

County or administrative area

Postcode

Country

Personal Licence number (if known)

Issuing licensing authority (if known)

**PROPOSED DESIGNATED PREMISES SUPERVISOR CONSENT**

How will the consent form of the proposed designated premises supervisor be supplied to the authority?

- Electronically, by the proposed designated premises supervisor
- As an attachment to this application

Reference number for consent form (if known)

If the consent form is already submitted, ask the proposed designated premises supervisor for its 'system reference' or 'your reference'.

**Section 16 of 21**

**ADULT ENTERTAINMENT**

Highlight any adult entertainment or services, activities, or other entertainment or matters ancillary to the use of the premises that may give rise to concern in respect of children

Give information about anything intended to occur at the premises or ancillary to the use of the premises which may give rise to concern in respect of children, regardless of whether you intend children to have access to the premises, for example (but not exclusively) nudity or semi-nudity, films for restricted age groups etc gambling machines etc.

NONE.

**Section 17 of 21**

**HOURS PREMISES ARE OPEN TO THE PUBLIC**

**Standard Days And Timings**

Continued from previous page...

MONDAY

Start

End

Start

End

Give timings in 24 hour clock.  
(e.g., 16:00) and only give details for the days  
of the week when you intend the premises  
to be used for the activity.

TUESDAY

Start

End

Start

End

WEDNESDAY

Start

End

Start

End

THURSDAY

Start

End

Start

End

FRIDAY

Start

End

Start

End

SATURDAY

Start

End

Start

End

SUNDAY

Start

End

Start

End

State any seasonal variations

For example (but not exclusively) where the activity will occur on additional days during the summer months.

NONE.

Non standard timings. Where you intend to use the premises to be open to the members and guests at different times from those listed in the column on the left, list below

For example (but not exclusively), where you wish the activity to go on longer on a particular day e.g. Christmas Eve.

Including bank holidays and public holidays.

Continued from previous page...

## Section 18 of 21

### LICENSING OBJECTIVES

Describe the steps you intend to take to promote the four licensing objectives:

a) General – all four licensing objectives (b,c,d,e)

List here steps you will take to promote all four licensing objectives together.

- Every supply of alcohol will be made by a personal license holder or a person authorized by a personal licence holders.
- A suitable evacuation plan in case of emergency is available and displayed.

b) The prevention of crime and disorder

- The premises shall have installed and maintain a closed circuit television surveillance (CCTV) system which at all times complies with the below requirements:
    - i. CCTV will be provided in the form a recordable system, capable of providing pictures of evidential quality in all lighting conditions particularly facial recognition;
    - ii. CCTV cameras shall cover all public areas including all entrances and exits and all areas where the sale of alcohol takes place;
    - iii. Equipment must be maintained in good working order, be correctly time and date stamped, recordings must be kept in good working order and kept for a minimum period of 31 days;
    - iv. At all times, whilst the premises is open for licensable activities, there are members of staff able to immediately provide viewable copies of recordings to the police or licensing authority staff upon reasonable request;
    - v. The recording equipment and data storage devices shall be kept in a secure environment and fitted with security functions (such as passwords) to prevent recordings being tampered with;
    - vi. An operational daily log report must be maintained endorsed by signature, indicating the system has been checked and is compliant: in the event of any failings these are to be recorded immediately.
  - An incident log shall be kept at the premises, and made immediately available to police or licensing authority staff upon request. The log will be kept as a bound document with individually numbered pages and be retained for a period of at least 6 months after the last incident recorded. The log will be completed as soon as is possible and within any case within 4 hours of the occurrence and shall record the following:
    - (a) all crimes reported to the venue
    - (b) all ejections of patrons
    - (c) any complaints received concerning crime and disorder
    - (d) any incidents of disorder
    - (e) all seizures of drugs or offensive weapons
    - (f) any faults in a CCTV system, searching equipment or scanning equipment mandated as a condition of the licence.
  - The premises shall have in place and operate a zero tolerance policy with regard to the use/possession of controlled drugs and psychoactive substances and advertise the same within the premises on posters and similar means. This policy shall specifically include but not be limited to:
    - i. Searching practices upon entry;
    - ii. Dealing with patrons suspected of using drugs on the premises;
    - iii. Scrutiny of spaces including toilets or outside areas;
    - iv. Clear expectations of staff roles (including the DPS, managers/supervisors and door supervisors);
    - v. Staff training regarding identification of suspicious activity and what action to take;
    - vi. The handling of items suspected to be illegal drugs or psychoactive substances
    - vii. Steps taken to discourage and disrupt drug use on the premises
    - viii. Steps to be taken to inform patrons of the premises drug policy/practices
- A copy of this policy document shall be lodged with the police and licensing authority.
- The premises will operate a zero tolerance policy to illegal drugs.

c) Public safety

Health and Safety risk assessment will be in place.

*Continued from previous page...*

- Fire risk assessment will be in place.
- Adequate fire fighting equipment will be provided and staff trained in fire prevention, emergency procedures and the use of fire fighting equipment. Emergency lighting and fire extinguishers installed on the premises.
- Fire equipments will be maintained periodically.
- Fire exits will be kept clear all the times
- Suitable first -aid kit available.
- For safety and security reasons there will be shutters at the front.

d) The prevention of public nuisance

- Clear and legible notices will be prominently displayed at all exits requesting customers to respect local residents and leave the area quietly. These signs shall be a minimum size of 200 x 150 mm.
- These notices shall be positioned at eye level and a location where those leaving the premises can read them.
- Clear and legible notices will be prominently displayed at any area used for smoking requesting customers to respect local residents and use the area quietly. These signs shall be a minimum size of 200 x 150 mm.
- The premises will operate as a restaurant for the sale of alcohol for consumption ON the premises:
  - i. In which customers will be seated at a table;
  - ii. Which will be provided substantial table meals that are prepared on the premises and are served and consumed at the table;
  - iii. Alcohol will not be sold, supplied, or consumed on the premises otherwise than to persons who are taking substantial table meals and provided always that the consumption of alcohol by such persons is ancillary to taking such meals.
  - iv. Service of alcohol shall be by waiter/waitress only. No self service for the alcoholic drinks will be available.
  - v. Empty glasses will be removed from the tables after they emptied.
- A written dispersal policy will be formulated and provided to the police and licensing authority which amongst other things details:
  - How patrons leaving the premises shall be directed away from the premises;
  - How patrons will be informed of the services of taxi and private hire operators;
  - What staff will be responsible for supervising those leaving the premises and how they will supervise such persons;
  - Any 'wind' down periods;
  - Methods to prevent re-entry to the premises;
  - How bottles and glasses will be prevented from being removed from the premises at closing time.
- Except when being used for entry or egress by a patron, all external windows and doors shall be kept shut at all times when music is being played and in any event after 21:00 hours at any other time.
- 11. After 22:30 no persons shall be admitted or re-admitted to the premises, except for persons who have temporarily left the premises to smoke.
- 12. After 22:30 patrons permitted to temporarily leave and then re-enter the premises, e.g. to smoke, shall not be permitted to take drinks or glass containers with them. Notices to that effect will be displayed at the premises exits.
- Waste collection arrangements done and collecting regularly.
- The restaurant frontage and the rear will be kept clean and tidy at all times.

e) The protection of children from harm

- A Challenge 25 scheme shall be operated, whereby any person who appears to be under the age of 25 years of age is required to produce on request an item which meets the mandatory age verification requirement and is either a:
  - Proof of age card bearing the PASS Hologram;
  - Photocard driving licence;
  - Passport; or
  - Ministry of Defence Identity Card.
- The premises shall clearly display signs advising customers that a 'Challenge 25' policy is in force.
- A refusals record shall be maintained at the premises which details all refusals to sell alcohol. Each entry shall, as a minimum, record the date and time of the refusal and the name of the staff member refusing the sale. All entries will be made as soon as possible and in any event within 4 hours of the refusal and the record will be made immediately available to police, trading standards or licensing authority staff upon reasonable request. The refusals record shall either be electronic or maintained in a bound document and retained for at least 12 months from the date of the last entry.



Continued from previous page...

## NOTES ON DEMONSTRATING ENTITLEMENT TO WORK IN THE UK

### Entitlement to work/immigration status for individual applicants and applications from partnerships which are not limited liability partnerships:

A licence may not be held by an individual or an individual in a partnership who is resident in the UK who:

- does not have the right to live and work in the UK; or
- is subject to a condition preventing him or her from doing work relating to the carrying on of a licensable activity.

Any premises licence issued in respect of an application made on or after 6 April 2017 will become invalid if the holder ceases to be entitled to work in the UK.

Applicants must demonstrate that they have an entitlement to work in the UK and are not subject to a condition preventing them from doing work relating to the carrying on of a licensable activity. They do this in one of two ways: 1) by providing with this application copies or scanned copies of the documents listed below (which do not need to be certified), or 2) by providing their 'share code' to enable the licensing authority to carry out a check using the Home Office online right to work checking service (see below).

### Documents which demonstrate entitlement to work in the UK

- An expired or current passport showing the holder, or a person named in the passport as the child of the holder, is a British citizen or a citizen of the UK and Colonies having the right of abode in the UK [please see note below about which sections of the passport to copy].
- An expired or current passport or national identity card showing the holder, or a person named in the passport as the child of the holder, is a national of a European Economic Area country or Switzerland.
- A Registration Certificate or document certifying permanent residence issued by the Home Office to a national of a European Economic Area country or Switzerland.
- A Permanent Residence Card issued by the Home Office to the family member of a national of a European Economic Area country or Switzerland.
- A **current** Biometric Immigration Document (Biometric Residence Permit) issued by the Home Office to the holder indicating that the person named is allowed to stay indefinitely in the UK, or has no time limit on their stay in the UK.
- A **current** passport endorsed to show that the holder is exempt from immigration control, is allowed to stay indefinitely in the UK, has the right of abode in the UK, or has no time limit on their stay in the UK.
- A **current** Immigration Status Document issued by the Home Office to the holder with an endorsement indicating that the named person is allowed to stay indefinitely in the UK or has no time limit on their stay in the UK, **when produced in combination with** an official document giving the person's permanent National Insurance number and their name issued by a Government agency or a previous employer.
- A birth or adoption certificate issued in the UK, **when produced in combination with** an official document giving the person's permanent National Insurance number and their name issued by a Government agency or a previous employer.
- A birth or adoption certificate issued in the Channel Islands, the Isle of Man or Ireland **when produced in combination with** an official document giving the person's permanent National Insurance number and their name issued by a Government agency or a previous employer.
- A certificate of registration or naturalisation as a British citizen, **when produced in combination with** an official document giving the person's permanent National Insurance number and their name issued by a Government agency or a previous employer.

*Continued from previous page...*

- A **current** passport endorsed to show that the holder is allowed to stay in the UK and is currently allowed to work and is not subject to a condition preventing the holder from doing work relating to the carrying on of a licensable activity.
- A **current** Biometric Immigration Document (Biometric Residence Permit) issued by the Home Office to the holder which indicates that the named person can currently stay in the UK and is allowed to work relation to the carrying on of a licensable activity.
- A **current** Residence Card issued by the Home Office to a person who is not a national of a European Economic Area state or Switzerland but who is a family member of such a national or who has derivative rights or residence.
- A **current** Immigration Status Document containing a photograph issued by the Home Office to the holder with an endorsement indicating that the named person may stay in the UK, and is allowed to work and is not subject to a condition preventing the holder from doing work relating to the carrying on of a licensable activity **when produced in combination with** an official document giving the person's permanent National Insurance number and their name issued by a Government agency or a previous employer.
- A Certificate of Application, **less than 6 months old**, issued by the Home Office under regulation 18(3) or 20(2) of the Immigration (European Economic Area) Regulations 2016, to a person who is not a national of a European Economic Area state or Switzerland but who is a family member of such a national or who has derivative rights of residence.
- Reasonable evidence that the person has an outstanding application to vary their permission to be in the UK with the Home Office such as the Home Office acknowledgement letter or proof of postage evidence, or reasonable evidence that the person has an appeal or administrative review pending on an immigration decision, such as an appeal or administrative review reference number.
- Reasonable evidence that a person who is not a national of a European Economic Area state or Switzerland but who is a family member of such a national or who has derivative rights of residence in exercising treaty rights in the UK including:-
  - evidence of the applicant's own identity – such as a passport,
  - evidence of their relationship with the European Economic Area family member – e.g. a marriage certificate, civil partnership certificate or birth certificate, and
  - evidence that the European Economic Area national has a right of permanent residence in the UK or is one of the following if they have been in the UK for more than 3 months:
    - (i) working e.g. employment contract, wage slips, letter from the employer,
    - (ii) self-employed e.g. contracts, invoices, or audited accounts with a bank,
    - (iii) studying e.g. letter from the school, college or university and evidence of sufficient funds; or
    - (iv) self-sufficient e.g. bank statements.

Family members of European Economic Area nationals who are studying or financially independent must also provide evidence that the European Economic Area national and any family members hold comprehensive sickness insurance in the UK. This can include a private medical insurance policy, an EHIC card or an S1, S2 or S3 form.

**Original documents must not be sent to licensing authorities.** If the document copied is a passport, a copy of the following pages should be provided:-

- (i) any page containing the holder's personal details including nationality;
- (ii) any page containing the holder's photograph;
- (iii) any page containing the holder's signature;
- (iv) any page containing the date of expiry; and
- (v) any page containing information indicating the holder has permission to enter or remain in the UK and is permitted to work.

*Continued from previous page...*

If the document is not a passport, a copy of the whole document should be provided.

Your right to work will be checked as part of your licensing application and this could involve us checking your immigration status with the Home Office. We may otherwise share information with the Home Office. Your licence application will not be determined until you have complied with this guidance.

#### **Home Office online right to work checking service**

As an alternative to providing a copy of the documents listed above, applicants may demonstrate their right to work by allowing the licensing authority to carry out a check with the Home Office online right to work checking service.

To demonstrate their right to work via the Home Office online right to work checking service, applicants should include in this application their 9-digit share code (provided to them upon accessing the service at <https://www.gov.uk/prove-right-to-work>) which, along with the applicant's date of birth (provided within this application), will allow the licensing authority to carry out the check.

In order to establish the applicant's right to work, the check will need to indicate that the applicant is allowed to work in the United Kingdom and is not subject to a condition preventing them from doing work relating to the carrying on of a licensable activity.

An online check will not be possible in all circumstances because not all applicants will have an immigration status that can be checked online. The Home Office online right to work checking service sets out what information and/or documentation applicants will need in order to access the service. Applicants who are unable to obtain a share code from the service should submit copy documents as set out above.

#### **Section 20 of 21**

#### **NOTES ON REGULATED ENTERTAINMENT**

*Continued from previous page...*

In terms of specific regulated entertainments please note that:

- Plays: no licence is required for performances between 08:00 and 23.00 on any day, provided that the audience does not exceed 500.
- Films: no licence is required for 'not-for-profit' film exhibition held in community premises between 08.00 and 23.00 on any day provided that the audience does not exceed 500 and the organiser (a) gets consent to the screening from a person who is responsible for the premises; and (b) ensures that each such screening abides by age classification ratings.
- Indoor sporting events: no licence is required for performances between 08.00 and 23.00 on any day, provided that the audience does not exceed 1000.
- Boxing or Wrestling Entertainment: no licence is required for a contest, exhibition or display of Greco-Roman wrestling, or freestyle wrestling between 08.00 and 23.00 on any day, provided that the audience does not exceed 1000. Combined fighting sports – defined as a contest, exhibition or display which combines boxing or wrestling with one or more martial arts – are licensable as a boxing or wrestling entertainment rather than an indoor sporting event.
- Live music: no licence permission is required for:
  - o a performance of unamplified live music between 08.00 and 23.00 on any day, on any premises.
  - o a performance of amplified live music between 08.00 and 23.00 on any day on premises authorised to sell alcohol for consumption on those premises, provided that the audience does not exceed 500.
  - o a performance of amplified live music between 08.00 and 23.00 on any day, in a workplace that is not licensed to sell alcohol on those premises, provided that the audience does not exceed 500.
  - o a performance of amplified live music between 08.00 and 23.00 on any day, in a church hall, village hall, community hall, or other similar community premises, that is not licensed by a premises licence to sell alcohol, provided that (a) the audience does not exceed 500, and (b) the organiser gets consent for the performance from a person who is responsible for the premises.
  - o a performance of amplified live music between 08.00 and 23.00 on any day, at the non-residential premises of (i) a local authority, or (ii) a school, or (iii) a hospital, provided that (a) the audience does not exceed 500, and (b) the organiser gets consent for the performance on the relevant premises from: (i) the local authority concerned, or (ii) the school or (iii) the health care provider for the hospital.
- Recorded Music: no licence permission is required for:
  - o any playing of recorded music between 08.00 and 23.00 on any day on premises authorised to sell alcohol for consumption on those premises, provided that the audience does not exceed 500.
  - o any playing of recorded music between 08.00 and 23.00 on any day, in a church hall, village hall, community hall, or other similar community premises, that is not licensed by a premises licence to sell alcohol, provided that (a) the audience does not exceed 500, and (b) the organiser gets consent for the performance from a person who is responsible for the premises.
  - o any playing of recorded music between 08.00 and 23.00 on any day, at the non-residential premises of (i) a local authority, or (ii) a school, or (iii) a hospital, provided that (a) the audience does not exceed 500, and (b) the organiser gets consent for the performance on the relevant premises from: (i) the local authority concerned, or (ii) the school proprietor or (iii) the health care provider for the hospital.

Continued from previous page...

- Dance: no licence is required for performances between 08.00 and 23.00 on any day, provided that the audience does not exceed 500. However, a performance which amounts to adult entertainment remains licensable.
- Cross activity exemptions: no licence is required between 08.00 and 23.00 on any day, with no limit on audience size for:
  - o any entertainment taking place on the premises of the local authority where the entertainment is provided by or on behalf of the local authority;
  - o any entertainment taking place on the hospital premises of the health care provider where the entertainment is provided by or on behalf of the health care provider;
  - o any entertainment taking place on the premises of the school where the entertainment is provided by or on behalf of the school proprietor; and
  - o any entertainment (excluding films and a boxing or wrestling entertainment) taking place at a travelling circus, provided that (a) it takes place within a moveable structure that accommodates the audience, and (b) that the travelling circus has not been located on the same site for more than 28 consecutive days.

## Section 21 of 21

### PAYMENT DETAILS

This fee must be paid to the authority. If you complete the application online, you must pay it by debit or credit card.

Premises Licence Fees are determined by the non-domestic rateable value of the premises.

To find out a premises non domestic rateable value go to the Valuation Office Agency site at [http://www.voa.gov.uk/business\\_rates/index.htm](http://www.voa.gov.uk/business_rates/index.htm)

Band A - No RV to £4300 £100.00

Band B - £4301 to £33000 £190.00

Band C - £33001 to £8700 £315.00

Band D - £87001 to £12500 £450.00\*

Band E - £125001 and over £635.00\*

\*If the premises rateable value is in Bands D or E and the premises is primarily used for the consumption of alcohol on the premises then you are required to pay a higher fee

Band D - £87001 to £12500 £900.00

Band E - £125001 and over £1,905.00

There is an exemption from the payment of fees in relation to the provision of regulated entertainment at church halls, chapel halls or premises of a similar nature, village halls, parish or community halls, or other premises of a similar nature. The costs associated with these licences will be met by central Government. If, however, the licence also authorises the use of the premises for the supply of alcohol or the provision of late night refreshment, a fee will be required.

Schools and sixth form colleges are exempt from the fees associated with the authorisation of regulated entertainment where the entertainment is provided by and at the school or college and for the purposes of the school or college.

If you operate a large event you are subject to ADDITIONAL fees based upon the number in attendance at any one time

Capacity 5000-9999 £1,000.00

Capacity 10000 -14999 £2,000.00

Capacity 15000-19999 £4,000.00

Capacity 20000-29999 £8,000.00

Capacity 30000-39000 £16,000.00

Capacity 40000-49999 £24,000.00

Capacity 50000-59999 £32,000.00

Capacity 60000-69999 £40,000.00

Capacity 70000-79999 £48,000.00

Capacity 80000-89999 £56,000.00

Capacity 90000 and over £64,000.00

\* Fee amount (£)

190.00

### DECLARATION

Continued from previous page...

[Applicable to individual applicants only, including those in a partnership which is not a limited liability partnership] I understand I am not entitled to be issued with a licence if I do not have the entitlement to live and work in the UK (or if I am subject to a condition preventing me from doing work relating to the carrying on of a licensable activity) and that my licence will become invalid if I cease to be entitled to live and work in the UK. The DPS named in this application form is entitled to work in the UK (and is not subject to conditions preventing him or her from doing work relating to a licensable activity) and I have seen a copy of his or her proof of entitlement to work, if appropriate

Ticking this box indicates you have read and understood the above declaration

This section should be completed by the applicant, unless you answered "Yes" to the question "Are you an agent acting on behalf of the applicant?"

\* Full name   
\* Capacity   
\* Date  /  /   
dd mm yyyy

Once you're finished you need to do the following:

1. Save this form to your computer by clicking file/save as...
2. Go back to <https://www.gov.uk/apply-for-a-licence/premises-licence/epping-forest/apply-1> to upload this file and continue with your application.

Don't forget to make sure you have all your supporting documentation to hand.

**IT IS AN OFFENCE LIABLE TO SUMMARY CONVICTION TO A FINE OF ANY AMOUNT UNDER SECTION 158 OF THE LICENSING ACT 2003, TO MAKE A FALSE STATEMENT IN OR IN CONNECTION WITH THIS APPLICATION**

**IT IS AN OFFENCE UNDER SECTION 24B OF THE IMMIGRATION ACT 1971 FOR A PERSON TO WORK WHEN THEY KNOW, OR HAVE REASONABLE CAUSE TO BELIEVE, THAT THEY ARE DISQUALIFIED FROM DOING SO BY REASON OF THEIR IMMIGRATION STATUS. THOSE WHO EMPLOY AN ADULT WITHOUT LEAVE OR WHO IS SUBJECT TO CONDITIONS AS TO EMPLOYMENT WILL BE LIABLE TO A CIVIL PENALTY UNDER SECTION 15 OF THE IMMIGRATION, ASYLUM AND NATIONALITY ACT 2006 AND PURSUANT TO SECTION 21 OF THE SAME ACT, WILL BE COMMITTING AN OFFENCE WHERE THEY DO SO IN THE KNOWLEDGE, OR WITH REASONABLE CAUSE TO BELIEVE, THAT THE EMPLOYEE IS DISQUALIFIED**

**OFFICE USE ONLY**

Applicant reference number	<input type="text"/>
Fee paid	<input type="text"/>
Payment provider reference	<input type="text"/>
ELMS Payment Reference	<input type="text"/>
Payment status	<input type="text"/>
Payment authorisation code	<input type="text"/>
Payment authorisation date	<input type="text"/>
Date and time submitted	<input type="text"/>
Approval deadline	<input type="text"/>
Error message	<input type="text"/>
Is Digitally signed	<input type="checkbox"/>

1 2 3 4 5 6 7 8 9 10 11 12 13 14 15 16 17 18 19 20 21 Next >

Consent of individual to being specified as premises supervisor

I MR. UGUR KESEN  
[full name of prospective premises supervisor]

of

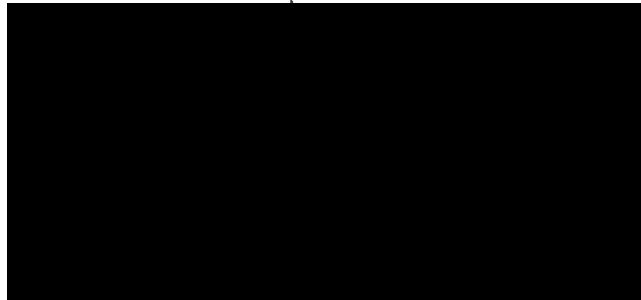

.....  
[home address of prospective premises supervisor]

hereby confirm that I give my consent to be specified as the designated premises supervisor in relation to the application for

NEW PREMISES LICENCE  
[type of application]

by

MR. UGUR KESEN  
[name of applicant]

relating to a premises licence NEW APPLICATION  
[number of existing licence, if any]

for

HARLEY'S BISTRO & LOUNGE  
184 HIGH STREET  
EPPING

CM16 4AQ  
[name and address of premises to which the application relates]



and any premises licence to be granted or varied in respect of this application made by

MR. UGUR KESEN  
*[name of applicant]*

concerning the supply of alcohol at

HARLEY'S BISTRO & LOUNGE  
184 HIGH STREET  
EPPING

CM16 4AQ  
*[name and address of premises to which application relates]*

I also confirm that I am entitled to work in the United Kingdom and am applying for, intend to apply for or currently hold a personal licence, details of which I set out below.

Personal licence number

WILL BE PROVIDED A.S.A.P  
*[insert personal licence number, if any]*

Personal licence issuing authority

WILL BE PROVIDED A.S.A.P  
*[insert name and address and telephone number of personal licence issuing authority, if any]*

Signed

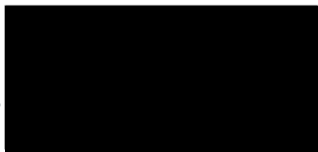

Name (please print)

UGUR KESEN

Date

14-07-2019

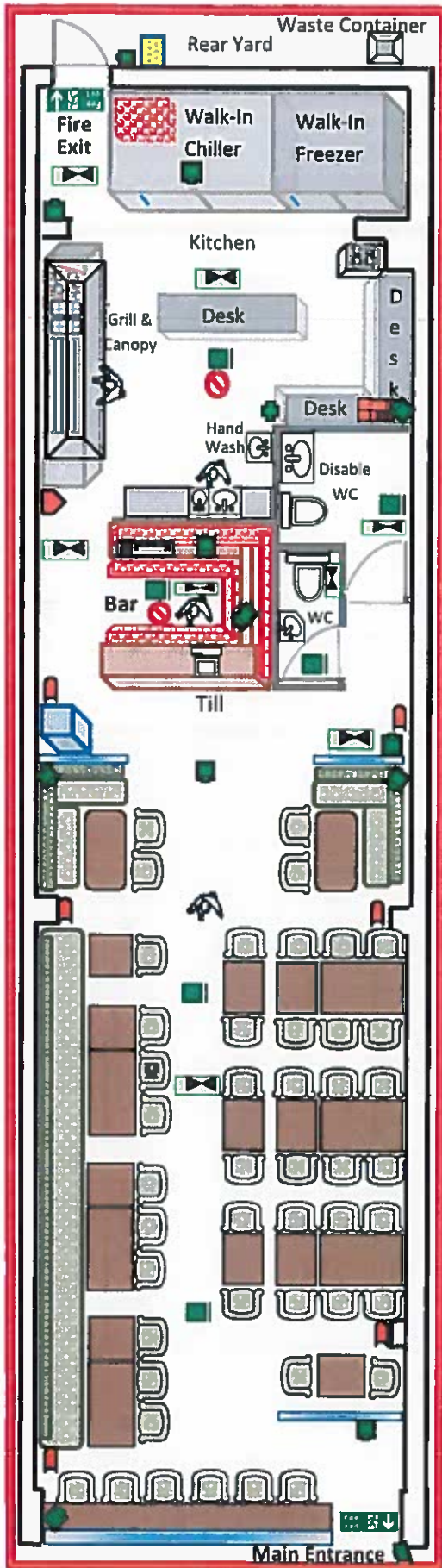

**Harley's**  
**Bistro & Lounge**  
 184 High Street, Epping  
 Essex EN8 7AP  
**LAYOUT**

**Alcohol Stock Location -1: Chiller**

Alcohol display shelves; under counter fridges & shelves above.

**Alcohol Stock Location-2: Bar, under counter shelves.**

- Legends**
- Fire Extinguisher
  - Fire Blanket
  - Heat Detectors
  - Smoke Detectors
  - Emergency Light
  - Cctv Cameras
  - First Aid Kit
  - Mains Electric
  - Mains Gas

**Assembly Point**

✓

Pavement located opposite side of the high street

**LICENSING ACT 2003**

**Notice of Application for a New Premises Licence under the  
Licensing Act 2003.**

Notice given on this day 16 July 2019 that, UGUR KESEN has applied to the Licensing Office of Epping Forest District Council for a new Premises Licence in respect of Harley's Bistro & Lounge 184 High Street, Epping, Essex, CM16 4AQ. The proposed Licence is for supply of alcohol for consumption on the premises from 10:00 to 22:30 Mondays to Sundays including Bank holidays and Public holidays. The register of licensed premises maintained at the Licensing Office of Epping Forest District Council, Civic Offices, High Street, Epping, Essex, CM16 4BZ. Applications for premises licences may be inspected at this office during office hours. Anyone wishing to oppose this application must give written notice to the Licensing Office within 28 days of this notice. It is an offence knowingly or recklessly to make a false statement in connection with an application which could lead to a fine on summary conviction for the offence unlimited fine.

# EPPING FOREST Guardian

## FRANCESCA IS LATEST LOVE ISLANDER

Boutique owner joins the show **SEE INSIDE**

news read by 57,259 people every week

Thursday, July 18, 2019

# ‘If we lose this library - we’ll lose it’

Hannah Hastings

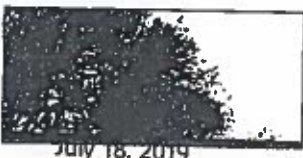

July 18, 2019

Campaigner says  
the tree is now to

However it is unclear if any support will be available after that.  
Cllr Sungar said Chigwell was one of the best used in the district.



### Public Notices

**Public Notice**  
London Borough of Waltham Forest  
**NOTIFICATION OF AN AREA FOR ADDITIONAL LICENSING**  
Section 56, Housing Act 2004

Waltham Forest (“the Authority”) in exercise of section 56 of the Housing Act 2004 (“the Act”) hereby designates the whole of the area in its district, as on Map 1. The designation has been made under the Act and was approved on 11th July 2019. The designation applies to private rented properties (“HMOs”) that are privately rented and licensed under section 56 of the Act and was approved on 11th July 2019. The designation applies to private rented properties (“HMOs”) that are privately rented and licensed under section 56 of the Act and was approved on 11th July 2019. The designation applies to private rented properties (“HMOs”) that are privately rented and licensed under section 56 of the Act and was approved on 11th July 2019.

London Borough of Waltham Forest, Town Hall, 1, E17 4JF; telephone number 020 8496 3000 (general enquiries) or 020 8498 4949 (for enquiries in respect of private rented property licensing) or email to [propertylicensing@walthamforest.gov.uk](mailto:propertylicensing@walthamforest.gov.uk)

### Public Notices

**Essex County Council**  
**(Galleyhill Road, Waltham Abbey)**  
**(Temporary Prohibition of Traffic) Order 2019**

Notice is hereby given that the Essex County Council intends, not less than seven days from the date of this notice, to make the above Order under Section 14(1) of the Road Traffic Regulation Act 1984.

**Effect of the order:** To temporarily close that length of Galleyhill Road, Waltham Abbey in the District of Epping Forest, from its junction with Breach Barns Lane for a distance of approximately 250m in a southerly direction. The closure is scheduled to commence on 6th August 2019 for 2 days, or where stated on a valid permit.

(BC005CC1W0006AUGIBYRCJTH – BT). The scheduled dates may vary for these works with appropriate signs showing and/or displayed on [www.roadworks.org](http://www.roadworks.org). The closure is required for the safety of the public and workforce while overhead structure works are undertaken by BT.

An alternative route is available via Galleyhill Road, Parklands, Paternoster Hill, Uphire Road, Horseshoe Hill, Long Street, Cobbinsend Road, Claverhambury Road and vice versa.

The Order will come into effect on 25th July 2019 and may continue in force for 18 months or until the works have been completed, whichever is the earlier.

### Announcements - Public Notices

**DISCLAIMER**  
Notice of Application for a New Premises Licence under the Licensing Act 2003

Notice given on this day 16 July 2019 that the Local Authority has applied to the Licensing Office of Epping Forest District Council for a new Premises Licence in respect of Harley's Music & Lounge, 184 High Street, Epping, Essex, CH16 4AQ. The proposed licence is for the supply of alcohol for consumption on the premises from 10:00 to 22:30 Mondays to Sundays including Bank Holidays and Public Holidays. The register of licensed premises maintained at the Licensing Office of Epping Forest District Council, Civic Offices, High Street, Epping, Essex, CH16 4BZ. Applications for premises licences may be inspected at this office during office hours. Anyone wishing to oppose this application must give written notice to the Licensing Office within 28 days of this notice. It is an offence knowingly or recklessly to make a false statement in connection with an application which could lead to a fine on summary conviction for the offence of perjury. Billerway - Coates - 1467813 181 092

LASER-GUN LEAFLET DELIVERY

CALL 0845 1999 830

ZOOMINILEAFLETS

# Something to say?

## Debbie Houghton

---

**From:** Peter Charman [REDACTED]  
**Sent:** 27 July 2019 12:56  
**To:** Licensing  
**Subject:** Harley's Bistro and Lounge consultation

**CAUTION: This Message originated outside of Epping Forest District Council. Do not click links or open attachments unless you recognise the sender and know the contents is safe.**

---

Good afternoon, I wish to make a representation to the licensing sub-committee regarding the application from Harley's Bistro and Lounge on the following grounds;

- The prevention of crime and disorder
- Public Safety
- The prevention of public nuisance
- The protection of children from harm

My principal concern is the proposed sale of alcohol Monday to Sunday 10am to 10.30pm. I believe such extended hours will increase the likelihood of crime and disorder, have a negative impact on public safety. cause public nuisance and potentially harm children.

I would like to see the sale of alcohol only from noon onwards and, if possible, limited to sale only with food. Also, I would like to see one day per week where no alcohol is served.

Best regards

Peter Charman  
[REDACTED] Flacks Mews  
Station Road  
Epping  
[REDACTED]

**Debbie Houghton**

---

**From:** Licensing Epping and Brentwood  
<licensing.epping.and.brentwood@essex.pnn.police.uk>  
**Sent:** 18 July 2019 15:00  
**To:** Licensing  
**Subject:** Applications

**CAUTION: This Message originated outside of Epping Forest District Council. Do not click links or open attachments unless you recognise the sender and know the contents is safe.**

---

Hi,

In respect of the following applications, Essex Police have **no representations** to make.

[REDACTED]  
PREMISES LICENCE – Harley's Bistro & Lounge, Epping  
[REDACTED]  
Many thanks

**Peter Jones (7706) MIOL, MBII**  
Essex Police Licensing Officer  
Epping Forest | Harlow  
Direct Tel. 01279 625405 | Internal. 313604  
Mob. 07870 909762 (only answered when on duty)

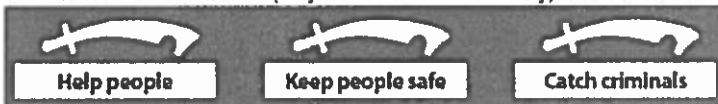

This email and any other accompanying document(s) contain information from Kent Police and/or Essex Police, which is confidential or privileged. The information is intended to be for the exclusive use of the individual(s) or bodies to whom it is addressed. The content, including any subsequent replies, could be disclosable if relating to a criminal investigation or civil proceedings. If you are not the intended recipient, be aware that any disclosure, copying, distribution or other use of the contents of this information is prohibited. If you have received this email in error, please notify us immediately by contacting the sender or telephoning Kent Police on 01622 690690 or Essex Police on 01245 491491, as appropriate. For further information regarding Kent Police's or Essex Police's use of personal data please go to <https://www.kent.police.uk/policy/privacy,-cookies-and-legal-notice/> or <https://www.essex.police.uk/copyright-privacy/>

## **Report to the Licensing Sub-Committee**

**Date of meeting: 17 September 2019**



**Epping Forest  
District Council**

**Subject:** Application for Variation of Premises Licence - Efezade, 12-14 The Broadway, Loughton

**Responsible Officer:** H. Ibrahim (01992) 564153))

**Democratic Services Officer:** S. Tautz (01992) 564180))

---

### **Recommendations/Decisions Required:**

**To consider an application for the variation of an existing Premises Licence under the Licensing Act 2003, with regard to Efezade, 12-14 The Broadway, Loughton.**

### **Application**

1. An application has been made by Cuma Erdogan for a variation to the premises licence for Efezade, 12-14 The Broadway, Loughton.
2. The application is for the following licensable activities:
  - (a) hours the premises will be open to the public - Monday to Sunday from 07:30am to 01:00am;
  - (b) supply of alcohol - Monday to Sunday from 10:00am to 01:00am;
  - (c) recorded music - Monday to Sunday from 10:00am to 01:00am; and
  - (d) late night refreshment - Monday to Sunday from 23:00pm to 01:00am.
3. The application was received on 1 August 2019. A copy of the present licence for the premises, the application for variation and the public notice are attached as an appendix to this report.

### **Licensing Act 2003**

4. When considering an application for a licence, the licensing authority must have regard to steps that are appropriate to the promotion of the licensing objectives. These are:
  - (a) the prevention of crime and disorder;
  - (b) public safety;
  - (c) the prevention of public nuisance; and
  - (d) the protection of children from harm.
5. The licensing authority must also have regard to its Statement of Licensing Policy and any guidance issued by the Secretary of State.

### **Consultation**

6. The responsible authorities have all been consulted with regard to the application, which was properly advertised at the premises and in a local newspaper.

7. The Council has received eighteen representations to the application, from the Council's Environmental Enforcement Team, Loughton Town Council, Loughton Residents Association and local residents. Essex Police and the council's Environmental Health Team have raised no objections to the application.
8. The representations made in respect of the application relate to the prevention of crime and disorder, public safety, the prevention of public nuisance and the protection of children from harm.
9. The Service Director (Planning Services) has advised that planning permission for a change of use (EPF/3136/16) to A3 use for the application premises currently has a condition that restricts the opening hours for members of the public until 23:00 and that the applicant would need to apply for a variation of the existing planning permission. Whilst the Sub-Committee will be aware that licensing does not take planning legislation into consideration, this information has been passed onto the applicant and is included in this report for information only.

### **Guidance Issued by the Secretary of State**

10. The Licensing Act 2003 provides that the licensing authority must 'have regard to' guidance issued by the Secretary of State under Section 182 of the Licensing Act 2003. Sections 2.1 to 2.32 of the Guidance are relevant to this application.

### **Options**

11. In determining the application, the Sub-Committee may take any of the following steps as it considers necessary for the promotion of the licensing objectives, namely:
  - (a) to modify the conditions of the licence; or
  - (b) to reject the whole or part of the application.
12. For the purposes of the Licensing Act 2003, the conditions of the licence are modified if any of them are altered or omitted or a new condition added.

### **Determination**

13. The Sub-Committee is asked to determine the application having regard to:
  - (a) the content of this report and representations;
  - (b) any additional information obtained from the hearing;
  - (c) the Council's statement of licensing policy;
  - (d) guidance issued by the Secretary of State, and
  - (e) the steps appropriate to promote the licensing objectives.

### **Appeal**

14. If any party is aggrieved with the decision of the Sub-Committee with regard to the application, they can appeal to the Magistrates Court. The appeal period is twenty-one days from the notification of the decision.

### **Background papers used in the preparation of this report:**

- The Licensing Act 2003  
<http://www.legislation.gov.uk/ukpga/2003/17/contents?view=plain>
- The Secretary of State's Guidance issued under Section 182 of the Licensing Act 2003  
<http://www.homeoffice.gov.uk/publications/alcohol-drugs/alcohol/guidance-section-182-licensing?view=Binary>
- Epping Forest District Council's statement of licensing policy.



**Attached documents**

- application for variation of premises licence;
- copy of the premises Licence;
- copy of the public notice;
- newspaper advert;
- representations from the Environmental Enforcement Team, Loughton Town Council, Loughton Residents Association and local residents.
- information received from the Service Director (Planning Services); and
- map showing the area of the application premises.

This page is intentionally left blank



Application to vary a premises licence under the Licensing Act 2003

PLEASE READ THE FOLLOWING INSTRUCTIONS FIRST

Before completing this form please read the guidance notes at the end of the form. If you are completing this form by hand please write legibly in block capitals. In all cases ensure that your answers are inside the boxes and written in black ink. Use additional sheets if necessary.

You may wish to keep a copy of the completed form for your records.

I/we MR. CUMA ERDOGAN  
(Insert name(s) of applicant)

being the premises licence holder, apply to vary a premises licence under Section 34 of the Licensing Act 2003 for the premises described in Part 1 below

Premises licence number	LN000002929
-------------------------	-------------

Part 1 – Premises Details

Postal address of premises or, if none, ordnance survey map reference or description			
EFEZABE 12-14 THE BROADWAY LOUGHTON ESSEX			
Post town		Postcode	16103ST
Telephone number at premises (if any)		0208 508 8811	
Non-domestic rateable value of premises		£ BAND B	

Part 2 – Applicant details

Daytime contact telephone number	[REDACTED]		
E-mail address (optional)	[REDACTED]		
Current postal address if different from premises address	—		
Post town	—	Postcode	—

**Part 3 – Variation**

Please tick as appropriate

Do you want the proposed variation to have effect as soon as possible?  Yes  No

If not, from what date do you want the variation to take effect?

DD	MM	YYYY

Do you want the proposed variation to have effect in relation to the introduction of the late night levy?  
(Please see guidance note 1)  Yes  No

Please describe briefly the nature of the proposed variation (Please see guidance note 2)

We would like to extend the sale of ~~LATE NIGHT~~ Refreshers  
alcohol to 01:00hrs. - Monday to Sunday.  
and to play recorded music until 01.00hrs

If your proposed variation would mean that 5,000 or more people are expected to attend the premises at any one time, please state the number expected to attend:

—
---

**Part 4 Operating Schedule**

Please complete those parts of the Operating Schedule below which would be subject to change if this application to vary is successful.

**Provision of regulated entertainment**

Please tick all that apply

- (a) Plays (if ticking yes, fill in box A)
- (b) Films (if ticking yes, fill in box B)
- (c) Indoor sporting events (if ticking yes, fill in box C)
- (d) Boxing or wrestling entertainment (if ticking yes, fill in box D)
- (e) Live music (if ticking yes, fill in box E)
- (f) Recorded music (if ticking yes, fill in box F)
- (g) Performances of dance (if ticking yes, fill in box G)
- (h) Anything of a similar description to that falling within (e), (f) or (g) (if ticking yes, fill in box H)

**Provision of late night refreshment** (if ticking yes, fill in box I)

**Supply of alcohol** (if ticking yes, fill in box J)

In all cases complete boxes K, L and M

A

Plays Standard days and timings (please read guidance note 7)			Will the performance of a play take place indoors or outdoors or both – please tick (please read guidance note 3)	Indoors	<input type="checkbox"/>
				Outdoors	<input type="checkbox"/>
				Both	<input type="checkbox"/>
Day	Start	Finish	Please give further details here (please read guidance note 4)		
Mon					
Tue					
Wed			State any seasonal variations for performing plays (please read guidance note 5)		
Thur					
Fri			Non standard timings. Where you intend to use the premises for the performance of plays at different times from those listed in the column on the left, please list (please read guidance note 6)		
Sat					
Sun					

**B**

<b>Films</b> Standard days and timings (please read guidance note 7)			<b><u>Will the exhibition of films take place indoors or outdoors or both – please tick</u></b> (please read guidance note 3)	Indoors	<input type="checkbox"/>			
				Outdoors	<input type="checkbox"/>			
				Both	<input type="checkbox"/>			
<b>Day</b>	<b>Start</b>	<b>Finish</b>	<b><u>Please give further details here</u></b> (please read guidance note 4)					
Mon								
Tue								
Wed						<b><u>State any seasonal variations for the exhibition of films</u></b> (please read guidance note 5)		
Thur								
Fri						<b><u>Non standard timings. Where you intend to use the premises for the exhibition of films at different times to those listed in the column on the left, please list</u></b> (please read guidance note 6)		
Sat								
Sun								

C

Indoor sporting events Standard days and timings (please read guidance note 7)			<u>Please give further details here</u> (please read guidance note 4)	
Day	Start	Finish		
Mon			<u>State any seasonal variations for indoor sporting events</u> (please read guidance note 5)	
Tue				
Wed				
Thur				
Fri				<u>Non standard timings. you intend to use the premises for indoor sporting events at different times to those listed in the column on the left, please list</u> (please read guidance note 6)
Sat				
Sun				

**D**

<b>Boxing or wrestling entertainments</b> Standard days and timings (please read guidance note 7)			<b><u>Will the boxing or wrestling entertainment take place indoors or outdoors or both – please tick</u></b> (please read guidance note 3)	Indoors	<input type="checkbox"/>
				Outdoors	<input type="checkbox"/>
Both	<input type="checkbox"/>				
<b>Day</b>	<b>Start</b>	<b>Finish</b>	<b><u>Please give further details here</u></b> (please read guidance note 4)		
Mon					
Tue					
<b>Wed</b>			<b><u>State any seasonal variations for boxing or wrestling entertainment</u></b> (please read guidance note 5)		
<b>Thur</b>					
<b>Fri</b>			<b><u>Non standard timings. Where you intend to use the premises for boxing or wrestling entertainment at different times to those listed in the column on the left, please list</u></b> (please read guidance note 6)		
<b>Sat</b>					
<b>Sun</b>					



**E**

<b>Live music</b> Standard days and timings (please read guidance note 7)			<b><u>Will the performance of live music take place indoors or outdoors or both – please tick</u></b> (please read guidance note 3)	Indoors	<input type="checkbox"/>
				Outdoors	<input type="checkbox"/>
				Both	<input type="checkbox"/>
<b>Day</b>	<b>Start</b>	<b>Finish</b>			
Mon			<b><u>Please give further details here</u></b> (please read guidance note 4)		
Tue					
Wed			<b><u>State any seasonal variations for the performance of live music</u></b> (please read guidance note 5)		
Thur					
Fri			<b><u>Non standard timings. Where you intend to use the premises for the performance of live music at different times to those listed in the column on the left, please list</u></b> (please read guidance note 6)		
Sat					
Sun					

F

Recorded music Standard days and timings (please read guidance note 7)			<u>Will the playing of recorded music take place indoors or outdoors or both – please tick</u> (please read guidance note 3)	Indoors	<input checked="" type="checkbox"/>
				Outdoors	<input type="checkbox"/>
				Both	<input type="checkbox"/>
Day	Start	Finish			
Mon	10AM	01.00	<u>Please give further details here</u> (please read guidance note 4)		
Tue	10.00	01.00			
Wed	10.00	01.00	<u>State any seasonal variations for the playing of recorded music</u> (please read guidance note 5)		
Thur	10.00	01.00			
Fri	10.00	01.00	<u>Non standard timings. Where you intend to use the premises for the playing of recorded music at different times to those listed in the column on the left, please list</u> (please read guidance note 6)		
Sat	10.00	01.00			
Sun	10.00	01.00			

**G**

<b>Performance of dance</b> Standard days and timings (please read guidance note 7)			<b><u>Will the performance of dance take place indoors or outdoors or both – please tick</u></b> (please read guidance note 3)	Indoors	<input type="checkbox"/>			
				Outdoors	<input type="checkbox"/>			
				Both	<input type="checkbox"/>			
<b>Day</b>	<b>Start</b>	<b>Finish</b>	<b><u>Please give further details here</u></b> (please read guidance note 4)					
Mon								
Tue								
Wed						<b><u>State any seasonal variations for the performance of dance</u></b> (please read guidance note 5)		
Thur								
Fri						<b><u>Non standard timings. Where you intend to use the premises for the performance of dance at different times to those listed in the column on the left, please list</u></b> (please read guidance note 6)		
Sat								
Sun								

H

<b>Anything of a similar description to that falling within (e), (f) or (g)</b> Standard days and timings (please read guidance note 7)			Please give a description of the type of entertainment you will be providing		
Day	Start	Finish	<u>Will this entertainment take place indoors or outdoors or both – please tick</u> (please read guidance note 3)	Indoors	<input type="checkbox"/>
Mon				Outdoors	<input type="checkbox"/>
				Both	<input type="checkbox"/>
Tue			<u>Please give further details here</u> (please read guidance note 4)		
Wed					
Thur			<u>State any seasonal variations for entertainment of a similar description to that falling within (e), (f) or (g)</u> (please read guidance note 5)		
Fri					
Sat			<u>Non-standard timings. Where you intend to use the premises for entertainment of a similar description to that falling within (e), (f) or (g) at different times from those listed in the column on the left, please list</u> (please read guidance note 6)		
Sun					

Late night refreshment Standard days and timings (please read guidance note 7)			<b><u>Will the provision of late night refreshment take place indoors or outdoors or both – please tick</u></b> (please read guidance note 3)	Indoors	<input checked="" type="checkbox"/>
				Outdoors	<input type="checkbox"/>
				Both	<input type="checkbox"/>
Day	Start	Finish			
Mon	23.00	01.00	<b><u>Please give further details here</u></b> (please read guidance note 4)		
Tue	23.00	01.00			
Wed	23.00	01.00	<b><u>State any seasonal variations for the provision of late night refreshment</u></b> (please read guidance note 5)		
Thur	23.00	01.00			
Fri	23.00	01.00	<b><u>Non standard timings. Where you intend to use the premises for the provision of late night refreshment at different times to those listed in the column on the left, please list</u></b> (please read guidance note 6)		
Sat	23.00	01.00			
Sun	23.00	01.00			

J

<b>Supply of alcohol</b> Standard days and timings (please read guidance note 7)			<b>Will the supply of alcohol be for consumption – please tick</b> (please read guidance note 8)	Indoors	<input checked="" type="checkbox"/>
				Outdoors	<input type="checkbox"/>
				Both	<input checked="" type="checkbox"/>
<b>Day</b>	<b>Start</b>	<b>Finish</b>	<b>State any seasonal variations for the supply of alcohol</b> (please read guidance note 5)		
Mon	10.00	01.00			
Tue	10.00	01.00			
Wed	10.00	01.00			
Thur	10.00	01.00			
<b>Fri</b>	<b>10.00</b>	<b>01.00</b>	<b>Non standard timings. Where you intend to use the premises for the supply of alcohol at different times to those listed in the column on the left, please list</b> (please read guidance note 6)		
Sat	10.00	01.00			
Sun	10.00	01.00			

K

Please highlight any adult entertainment or services, activities, other entertainment or matters ancillary to the use of the premises that may give rise to concern in respect of children (please read guidance note 9)

L

Hours premises are open to the public Standard days and timings (please read guidance note 7)			<u>State any seasonal variations</u> (please read guidance note 5)
Day	Start	Finish	
Mon	7.30	01.00	
Tue	7.30	01.00	
Wed	7.30	01.00	
Thur	7.30	01.00	
Fri	7.30	01.00	<u>Non standard timings. Where you intend the premises to be open to the public at different times to those listed in the column on the left, please list</u> (please read guidance note 6)
Sat	7.30	01.00	
Sun	7.30	01.00	

Please identify those conditions currently imposed on the licence which you believe could be removed as a consequence of the proposed variation you are seeking

Please tick as appropriate

- I have enclosed the premises licence
- I have enclosed the relevant part of the premises licence

If you have not ticked one of these boxes, please fill in reasons for not including the licence or part of it below

Reasons why I have not enclosed the premises licence or relevant part of premises licence

**M** – Describe the steps you intend to take to promote the four licensing objectives as a result of the proposed variation:

(a) General – all four licensing objectives (b, c, d and e) (please read guidance note 10)

AS ANNEX 2 - NOTES FOR GUIDANCE.

(b) The prevention of crime and disorder

AS ANNEX 2

(c) Public safety

AS ANNEX 2 .

(d) The prevention of public nuisance

AS ANNEX 2.  
NOTE Music after 23.00 is background only.

(e) The protection of children from harm

AS ANNEX 2 .



Checklist:

Please tick to indicate agreement

- I have made or enclosed payment of the fee; or
- I have not made or enclosed payment of the fee because this application has been made in relation to the introduction of the late night levy
- I have sent copies of this application and the plan to responsible authorities And others where applicable
- I understand that I must now advertise my application
- I have enclosed the premises licence or relevant part of it or explanation
- I understand that if I do not comply with the above requirements my application will be rejected

**DECLARATION**

**IT IS AN OFFENCE, LIABLE ON SUMMARY CONVICTION TO A FINE NOT EXCEEDING LEVEL 5 ON THE STANDARD SCALE, UNDER SECTION 158 OF THE LICENSING ACT 2003, TO MAKE A FALSE STATEMENT IN OR IN CONNECTION WITH THIS APPLICATION.**

**APPLICABLE TO INDIVIDUAL APPLICANTS ONLY, INCLUDING THOSE IN A PARTNERSHIP WHICH IS NOT A LIMITED LIABILITY PARTNERSHIP] I UNDERSTAND I AM NOT ENTITLED TO BE ISSUED WITH A LICENCE IF I DO NOT HAVE THE ENTITLEMENT TO LIVE AND WORK IN THE UK (OR IF I AM SUBJECT TO A CONDITION PREVENTING ME FROM DOING WORK RELATING TO THE CARRYING ON OF A LICENSABLE ACTIVITY) AND THAT MY LICENCE WILL BECOME INVALID IF I CEASE TO BE ENTITLED TO LIVE AND WORK IN THE UK . THE DPS NAMED IN THIS APPLICATION FORM IS ENTITLED TO WORK IN THE UK (AND IS NOT SUBJECT TO CONDITIONS PREVENTING HIM OR HER FROM DOING WORK RELATING TO A LICENSABLE ACTIVITY) AND I HAVE SEEN A COPY OF HIS OR HER PROOF OF ENTITLEMENT TO WORK, IF APPROPRIATE**

**Part 5 – Signatures** (please read guidance note 11)

**Signature of applicant (the current premises licence holder) or applicant’s solicitor or other duly authorised agent** (please read guidance note 12). If signing on behalf of the applicant, please state in what capacity

Signature	[REDACTED]
Date	03/07/2019
Capacity	CURRENT PREMISES LICENCE HOLDER

**Where the premises licence is jointly held, signature of second applicant (the current premises licence holder) or second applicant’s solicitor or other authorised agent** (please read guidance note 13). If signing on behalf of the applicant, please state in what capacity.

Signature	
Date	
Capacity	

Contact name (where not previously given) and address for correspondence associated with this application (please read guidance note 14)

Post town		Postcode	
Telephone number (if any)			
If you would prefer us to correspond with you by email, your email address (optional)			

# PREMISES LICENCE

## Part A



Premises licence number:

LN/000002929

### Part 1 – Premises details:

Postal address of premises, or if none, ordnance survey map reference or description:

Efezade, 12-14 The Broadway, Loughton, Essex, IG10 3ST

Post Town:

Post code: IG10 3ST

Telephone number:

Where the licence is time limited the dates: N/A

Licensable activities authorised by the licence:

Supply of Alcohol Monday – Sunday 10.00-23.00

The times the licence authorises the carrying out of licensable activities:

Supply of Alcohol Monday – Sunday 10.00-23.00

The opening hours of the premises:

Monday – Sunday 7.30 – 23.00

Where the licence authorises supplies of alcohol whether these are on and / or off supplies:

On and Off

Name, (registered) address, telephone number and e-mail (where relevant) of holder of premises licence:

Mr Cuma Erdogan  
[REDACTED]

**Registered number of holder, for example company number, charity number (where applicable):**

N/A

**Name, address and telephone number of designated premises supervisor where the premises licence authorises the supply of alcohol:**

Mr Cuma Erdogan

[REDACTED]

**Personal licence number and issuing authority of personal licence held by designated premises supervisor where the premises licence authorises for the supply of alcohol:**

LN000004124 Haringey Council

**If the Premises Licence has conditions in respect of Door Supervision  
except theatres, cinemas, bingo halls and casinos**

1. Where a premises licence includes a condition that at specified times one or more individuals must be at the premises to carry out a security activity, each such individual must:
  - (a) be authorised to carry out that activity by a licence granted under the Private Security Industry Act 2001; or
  - (b) be entitled to carry out that activity by virtue of section 4 of the Act.
  
2. But nothing in subsection (1) requires such a condition to be imposed:
  - (a) in respect of premises within paragraph 8(3)(a) of Schedule 2 to the Private Security Industry Act 2001 (c12) (premises with premises licences authorising plays or films); or
  - (b) in respect of premises in relation to:
    - (i) any occasion mentioned in paragraph 8(3)(b) or (c) of that Schedule (premises being used exclusively by club with club premises certificate, under a temporary event notice authorising plays or films or under a gaming licence), or
    - (ii) any occasion within paragraph 8(3)(d) of that Schedule (occasions prescribed by regulations under that Act).
  
3. For the purposes of this section:
  - (a) "security activity" means an activity to which paragraph 2(1)(a) of that Schedule applies, and, which is licensable conduct for the purposes of that Act, (see Section 3(2) of that Act) and
  - (b) paragraph 8(5) of that Schedule (interpretation of references to an occasion) applies as it applies in relation

- (c) "relevant person" means, in relation to premises in respect of which there is in force a premises licence –
- (i) The holder of the premises licence
  - (ii) The designated premises supervisor (if any) in respect of such a licence, or
  - (iii) The personal licence holder who makes or authorises a supply of alcohol under such a licence;
- (d) "relevant person" means, in relation to premises in respect of which there is in force a club premises certificate, any member or officer of the club present on the premises in a capacity which enables the member or officer to prevent the supply in question; and
- (e) "value added tax" means value added tax charged in accordance with the Value Added Tax Act 1994.
3. Where the permitted price given by Paragraph (b) of paragraph 2 would (apart from the paragraph) not be a whole number of pennies, the price given by that sub-paragraph shall be taken to be the price actually given by that sub-paragraph rounded up to the nearest penny.
4. (1) Sub-paragraph (2) applies where the permitted price given by Paragraph (b) of paragraph 2 on a day ("the first day") would be different from the permitted price on the next day ("the second day") as a result of a change to the rate of duty or value added tax.
- (2) The permitted price which would apply on the first day applies to sales or supplies of alcohol which take place before the expiry of the period of 14 days beginning on the second day.

### **If the Premises Licence allows Exhibition of Films**

1. Where a premises licence authorises the exhibition of films, the licence must include a condition requiring the admission of children to the exhibition of any film to be restricted in accordance with this section.
2. Where the film classification body is specified in the licence, unless subsection (3)(b) applies, admission of children must be restricted in accordance with any recommendation by that body.
3. Where
  - (a) The film classification body is not specified in the licence, or
  - (b) The relevant licensing authority has notified the holder of the licence that this subsection applies to the film in question, admission of children must be restricted in accordance with any recommendation made by that licensing authority.
4. In this section "children" means any person aged under 18; and

"film classification body" means the person or persons designated as the authority under Section 4 of the Video Recordings Act 1984(c39) (authority to determine suitability of video works for classification).

5. (1) The premises licence holder or club premises certificate holder must ensure that an age verification policy is adopted in respect of the premises in relation to the sale or supply of alcohol.
  - (2) The designated premises supervisor in relation to the premises licences must ensure that the supply of alcohol at the premises is carried on in accordance with the age verification policy.
  - (3) The policy must require individuals who appear to the responsible person to be under 18 years of age (or such older age as may be specified in the policy) to produce on request, before being served alcohol, identification bearing their photograph, date of birth and either:-
    - (a) a holographic mark or
    - (b) an ultraviolet feature
6. The responsible person shall ensure that –
- (a) where any of the following alcoholic drinks is sold or supplied for consumption on the premises (other than alcoholic drinks sold or supplied having been made up in advance ready for sale or supply in a securely closed container) it is available to customers in the following measures –
    - (i) beer or cider: ½ pint;
    - (ii) gin, rum, vodka or whisky: 25 ml or 35 ml; and
    - (iii) still wine in a glass: 125 ml; and
  - (b) these measures are displayed in a menu, price list or other printed material which is available to customers on the premises; and
  - (c) where a customer does not in relation to a sale of alcohol specify the quantity of alcohol to be sold, the customer is made aware that these measures are available.

### Minimum Drinks Pricing

1. A relevant person shall ensure that no alcohol is sold or supplied for consumption on or off the premises for a price which is less than the permitted price
2. For the purposes of the condition set out in paragraph 1 –
  - (a) “duty” is to be construed in accordance with the Alcoholic Liquor Duties Act 1979
  - (b) “permitted price” is the price found by applying the formula –
 
$$P = D + (D \times V)$$

Where –

    - (i) P is the permitted price
    - (ii) D is the amount of duty chargeable in relation to the alcohol as if the duty were charged on the date of the sale or supply of the alcohol, and
    - (iii) V is the rate of value added tax chargeable in relation to the alcohol as if the value added tax were charged on the date of the sale or supply of the alcohol;

## **Annex 2 – Conditions consistent with the Operating Schedule:**

### **The Prevention of Crime and Disorder.**

The current Security measures will remain in operation, and all the staff will be fully trained in this area. Sufficient staff will be on duty at all busy times and staff will refuse entry to any customer who in their opinion appears to be intoxicated. CCTV cameras will be in operation during the opening hours and also for a period of 2 hours after the premises closes. The time and date stamp will be correct at the time of all recordings and will be generated onto both recorded and real time images. A camera will record clear images of all customers from the waist and above at the entrance and exit of the premise. Recordings will be maintained for 31 days and, in the event of an incident or investigation of an offence, will be available for Police and or Responsible Authorities to view on request and will be downloaded onto a removable format and will be provided to Police and or Responsible Authorities within 48 hours of a request.

In the event of a technical failure, the premises licence holder will ensure that the DPS, or other named person in their absence, informs the Licensing Authority and Police as soon as is reasonably practicable. This information will be contemporaneously recorded in the incident register and will include the time, date, and means that this was done and also to whom the information was reported to. Equipment failures will be repaired without undue delay and the Licensing Authority and the Police will be informed when the fault is rectified.

The managers will develop and maintain a good relationship with the Police, neighbours to the premises and the Licensing Authority to ensure that the business becomes a valuable entity within the community.

Alcohol sales will be by waiter/waitress to a customer who is seated at a table and consumed at the table. Save for takeaway orders which must be ancillary to food ordered for takeaway. No vertical drinking shall be permitted.

### **Public Safety**

The premises will operate to a high standard and will continue to do so in terms of the sale of alcohol. All staff will be fully trained in their responsibilities with regard to the sale of alcohol. Staff will be re-trained every 6 months with recorded training records kept for inspection. The DPS will maintain a DPS written authorisation sheet which will show the names of staff members who have been given delegated authority to authorise the sale of alcohol. Staff will be trained to be alert to any potential danger to customers and react accordingly, if they are unable to quickly diffuse the situation without risk to customer or staff they are then instructed to call the police. Effective management and supervision of the premises will be maintained at all times. The premises will comply with all current Health and Safety and Fire legislation. There will be no smoking on the premises and free drinking water will be made available upon request. There will be access to licensed taxi and private hire services for customers if required.

### **Prevention of Public nuisance**

Customers will be requested to leave the premises in a quiet and orderly manner, a sign will also be displayed asking customers to leave the premises quietly.



### **The Protection of children from harm**

Only photographic ID is acceptable (passport, driving licence, proof of age card with PASS hologram and Military ID) If a customer appears to be under the age of 25, then they will be challenged to provide ID. If the customer is unable to provide recognised identification then no sale of alcohol will be made. If it becomes known that a customer intends to purchase alcohol with the intention to supply to a minor then that sale must be refused. All refused sales of alcohol will be recorded in a refusals book which will be made available for inspection by the Police or Licensing officers of the Local Authority upon request.

**Annexe 3 – Conditions attached after a hearing by the licensing authority:**

N/A

**Annexe 4 – Plans:**

Plans held at Epping Forest District Council

**Mandatory Conditions**  
**All Premises Licence authorising supply of alcohol**

The licence is granted subject to the Mandatory conditions for sale of alcohol as set out in the Licensing Act 2003 as amended by the Licensing Act 2003 (Mandatory Licensing Conditions) Order 2010 and Order 2014.

1. No supply of alcohol may be made under the Premises Licence –
  - (a) At a time when there is no Designated Premises Supervisor in respect of the Premises Licence; or
  - (b) At a time when the Designated Premises Supervisor does not hold a Personal Licence or his Personal Licence is suspended
2. Every supply of alcohol under the Premises Licence must be made, or authorised by a person who holds a Personal Licence.
3. (1) The responsible person must ensure that staff on relevant premises do not carry out, arrange or participate in any irresponsible promotions in relation to the premises.
  - (2) In this paragraph, an irresponsible promotion means any one or more of the following activities, or substantially similar activities, carried on for the purpose of encouraging the sale or supply of alcohol for consumption on the premises.
    - a) games or other activities which require or encourage, or are designed to require or encourage, individuals to –
      - (i) drink a quantity of alcohol within a time limit (other than to drink alcohol sold or supplied on the premises before the cessation of the period in which the responsible person is authorised to sell or supply alcohol), or
      - (ii) drink as much alcohol as possible (whether within a time limit or otherwise);
    - b) provision of unlimited or unspecified quantities of alcohol free or for a fixed or discounted fee to the public or to a group defined by a particular characteristic in a manner which carries a significant risk of undermining a licensing objective;
    - c) provision of free or discounted alcohol or any other thing as a prize to encourage or reward the purchase and consumption of alcohol over a period of 24 hours or less in a manner which carries a significant risk of undermining a licensing objective;
    - d) selling or supplying alcohol in association with promotional posters or flyers on, or in the vicinity of, the premises which can reasonably be considered to condone, encourage or glamorise anti-social behaviour or to refer to the effects of drunkenness in any favourable manner.
    - e) dispensing alcohol directly by one person into the mouth of another (other than where that other person is unable to drink without assistance by reason of disability).
4. The responsible person must ensure that free potable water is provided on request to customers where it is reasonably available.

Notice of Application for a Variation Premises Licence  
under the Licensing Act 2003

Notice is given this day 1st of August 2019 that Cuma Erdogan of 12-14 The Broadway Loughton Essex IG10 3ST has applied to the Licensing office of Epping Forest District Council for a Premises Licence in respect of Efezade 12-14 The Broadway Loughton Essex IG10 3ST

The proposed licence is for the sale of alcohol (on and off), Recorded Music from 22:00 to 01.00 hours Monday to Sunday and for the sale of late night refreshments from 23:00 to 01.00 hours Monday to Sunday

The register of licensed premises is maintained at the Licensing Office of Epping Forest District Council, Civic Offices, High Street, Epping, Essex, CM16 4BZ. Applications for premises licences may be inspected at this office during office hours. Anyone wishing to oppose this application must give written notice to the Licensing Office within 28 days of this notice.

It is an offence knowingly or recklessly to make a false statement in connection with an application which could lead to a fine on summary conviction (maximum £5000)

▶ Announcements - Public Notices

▶ Announcements - Public Notices

▶ Announcements - Public Notices

▶ Announcements - Public Notices

**Notice of Application for a Variation Premises Licence under the Licensing Act 2003**

Notice is given this day 1st of August 2019 that Cuma Erdogan of 12-14 The Broadway Loughton Essex IG10 3ST has applied to the Licensing office of Epping Forest District Council for a Premises Licence in respect of Elotade 12-14 The Broadway Loughton Essex IG10 3ST. The proposed licence is for the sale of Alcohol on and off the premises and recorded music from 22:00 to 01:00 hrs Monday to Sunday, and also for late night refreshments from 23:00 to 01:00 hrs. The opening times of the premises will be Monday to Sunday 07:30 to 01:00. The register of licensed premises is maintained at the Licensing Office of Epping Forest District Council, Civic Offices, High Street, Epping, Essex, CM16 4BZ. Applications for premises licences may be inspected at this office during office hours. Anyone wishing to oppose this application must give written notice to the Licensing Office within 28 days of this notice. It is an offence knowingly or recklessly to make a false statement in connection with an application which could lead to a fine on summary conviction (maximum £5000).

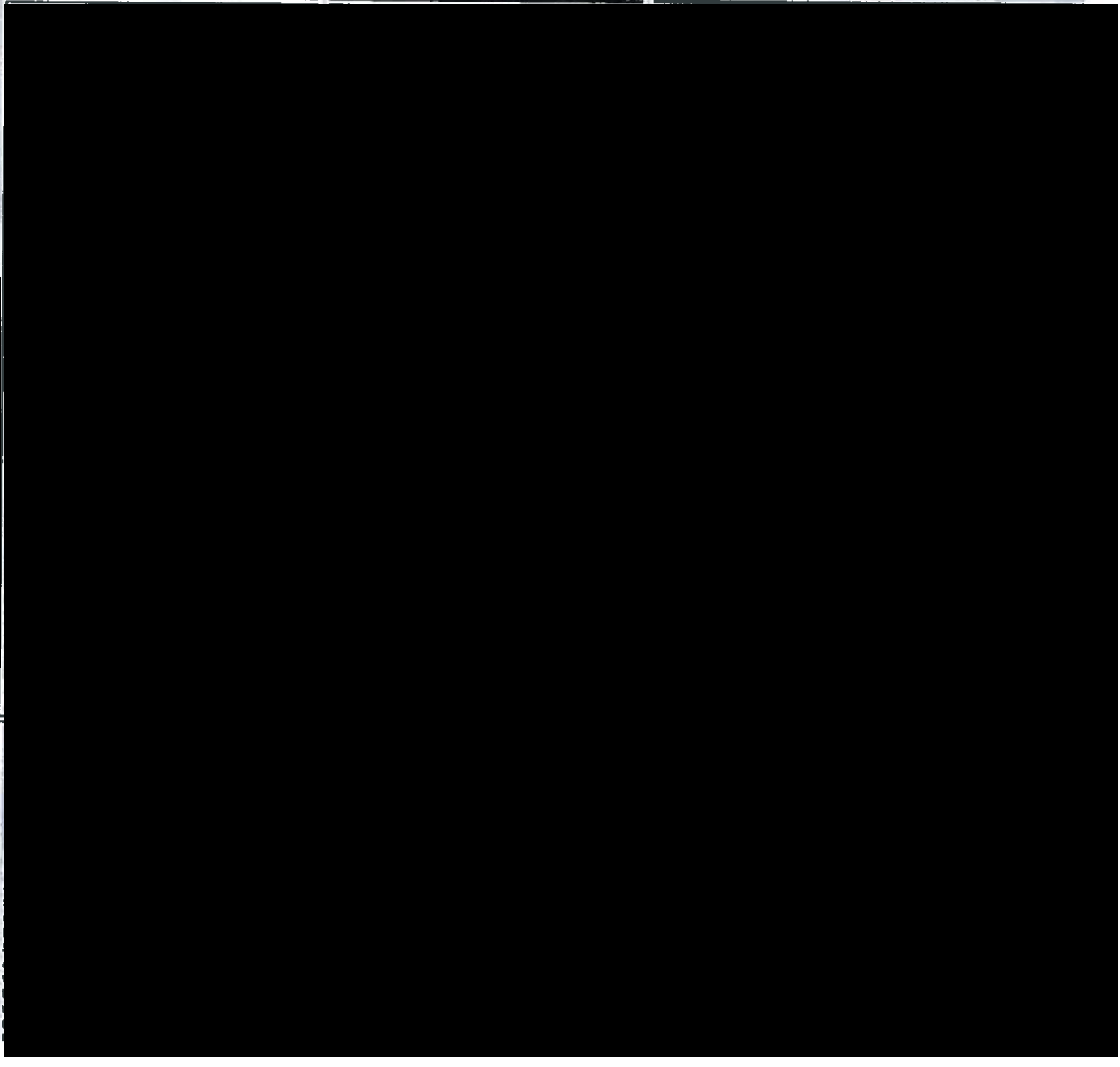
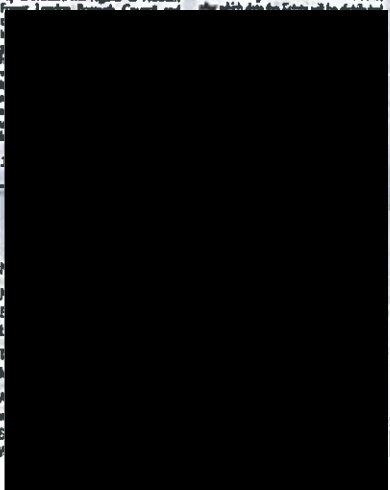

**Handan Ibrahim**

---

**From:** Michael Richardson  
**Sent:** 20 August 2019 13:09  
**To:** Handan Ibrahim; Denise Bastick  
**Cc:** Licensing  
**Subject:** WK201923325 - Comments regarding Efezade, 12-14 the Broadway  
**Attachments:** MEMO6.docx; Efezade Comments.docx

Hi Handan/Denise

Please find attached my comments regarding the above application

Regards

Mike

Michael Richardson  
Senior Environmental Enforcement Officer  
Community Resilience Team  
Communities & Partnerships Directorate  
Epping Forest District Council  
High Street  
Epping  
Essex  
CM16 4BZ

(01992) 564422

[mrichardson@eppingforestdc.gov.uk](mailto:mrichardson@eppingforestdc.gov.uk)

Date: 20 August 2019

Mr Cuma Erdogan  
Efezade  
12-14 The Broadway  
Loughton  
Essex  
IG10 3ST

Civic Offices  
High Street  
Epping  
Essex  
CM16 4BZ

Our Ref: WK/201923325  
Your Ref:

Dear Sir:

**Licensing Act 2003  
Efezade, 12-14 The Broadway, Loughton, Essex, IG10 3ST**

On behalf of the Council's Community & Partnerships Directorate, I confirm receipt of a copy of your application dated 3 July 2019, which was re submitted to the Council on 31 July 2019, regarding the above mentioned property, in relation to the Licensing objective the Prevention of Public nuisance.

It would appear that this application is the same as that was received in early July, and to which made representations in my letter, dated 15 July 2019.

My comments in this letter remain the same, but for clarity, I have outlined them again in this letter – and have made the following representation to the Council's Licensing Section with regard to the Licensing objective – Prevention of Public nuisance:

My main concern is that the extension of the licensable hours will go on until 01.00 hours every day of the week. Because of the residential nature of The Broadway, particularly late at night, any noise from the restaurant will cause a public nuisance, particularly in the early hours of the morning.

As such, I cannot support the extension of the hours of opening, due to noise from customers as they leave at 01.00 hours, and the potential for loud recording music, in the early hours.

As you are aware, complaints have been received in the recent past where loud music from Efezade has caused disturbance to residents of The Broadway during the current licensable hours. Whilst I appreciate that you indicate that music after 23.00 hours will be background music only, I do not consider that this is adequate to address the concerns that I have regarding the music causing a public nuisance later in the evening. This is due to the structure of the building, current positioning of the speakers, and the reduction of the background noise levels as the night progresses.



In addition, I am concerned that the noise from customers as they leave the site at 01.00 will cause significant disturbance, from loud voices and vehicle noise. Licenced premises regularly have issues with noise from customers as they leave, and I believe that the lateness of 01.00hours is unacceptable in this location, particularly due to the close proximity to residents above and opposite the site, and that as customers leave in the near vicinity, they are likely to cause a public nuisance.

---

Similarly, I would not want to see customers sitting outside after 23.00 hours, as this will also cause a public nuisance in the area.

As such, I am unable to recommend the extension of business until 01.00, due to the potential of a public nuisance being caused from amplified music and customers.

If you would like to discuss the matter or have any written comments, please do not hesitate to contact me.

**I should be happy to withdraw the representations if the operating schedule is amended or if you agree to suitable condition being imposed as part of the licence, or if you provide sufficient evidence to confirm that the representation can be withdrawn.**

Please confirm your comments in writing (by letter or email). I will inform the Council's Licensing Section if satisfied that the representations can be withdrawn.

Yours faithfully

Michael Richardson  
Senior Environmental Enforcement Officer  
Tel No: (01992) 564422  
Email: [mrichardson@eppingforestdc.gov.uk](mailto:mrichardson@eppingforestdc.gov.uk)

c.c. Licensing Section

**Handan Ibrahim**

---

**From:** Debra Paris <Debra.Paris@loughton-tc.gov.uk>  
**Sent:** 21 August 2019 12:00  
**To:** Handan Ibrahim; Denise Bastick  
**Subject:** Licensing Comments - The Hub, 3 The Broadway, Loughton, IG10 3SP; The Loughton Club, 8 Station Road, Loughton, IG10 4NX; and Efezade, 12-14 The Broadway, Loughton, IG10 3ST

**CAUTION: This Message originated outside of Epping Forest District Council. Do not click links or open attachments unless you recognise the sender and know the contents is safe.**

Dear Handan/Denise

Please find below the comments of the Planning & Licensing Committee in respect of the above licensing applications, following its meeting on 19 August 2019, where these matters were considered:

**Notice of application for a new premises licence under the Licensing Act 2003 in respect of The Hub, 3 The Broadway, Loughton, IG10 3SP**

A member of the public with an interest in this application addressed the meeting.

The Committee NOTED the contents of two letters of objection.

The Committee OBJECTED to this application on the grounds of all four licensing objectives: the prevention of crime and disorder; public safety; the prevention of public nuisance; and the protection of children from harm.

The application would be detrimental to the amenity of the residents of Landmark House on the following grounds:

- i) noise pollution and disturbance from patrons of the establishment along with the proposed live and recorded music;
- ii) concerns for anti-social behaviour and the increased risk of crime due to the licence for alcohol and late hours, with people loitering in the surrounding area posing a potential risk to the safety of residents and other members of the public;
- iii) the proposal does not conform to other operating hours for licensed premises in the locality that are in such close proximity to residential dwellings – the requested hours ending much too late;
- iv) increase in litter, odours and noise disturbances caused by the patrons smoking, vomiting and drunken behaviour in the street along with the increase in traffic from the use of personal vehicles and taxis; and
- v) the potential harm caused to the health of residents with balconies/windows above the premises arising from patrons who congregate to smoke outside the bar.

If Epping Forest District Council, Licensing Unit, is minded to grant this licence members requested that:

live and recorded music be limited to inside only, with sound limiting equipment installed and sufficient sound-proofing to protect the amenity of the residents of Landmark House; and that licensing hours for the playing of music be limited to 9pm Sunday – Thursday and until 10pm Friday – Saturday;  
the sale of alcohol be restricted to 10.30pm Sunday – Thursday and until 11pm Friday – Saturday, with opening hours ceasing at 11pm Sunday – Thursday and 11.30pm Friday – Saturday.

---

**Notice of application for a new premises licence under the Licensing Act 2003 in respect of The Loughton Club, 8 Station Road, Loughton, IG10 4NX**

The Committee had NO OBJECTION to this application.

---

**Notice of application to vary a premises licence under the Licensing Act 2003 in respect of Efezade, 12-14 The Broadway, Loughton, IG10 3ST – Min no PL720.1**

The Committee NOTED the contents of a letter of objection.

The Committee OBJECTED to this proposed licensing variation on the grounds of the prevention of crime and disorder and the prevention of public nuisance, confirming that the property had residential accommodation above and the occupants would be adversely affected by the late operation of this licence.

If Epping Forest District Council, Licensing Unit, is minded to grant this licence the Committee requested that the hours for the sale of alcohol be limited to 11pm Sunday to Thursday, and 12pm Friday to Saturday; and for no recorded music to be audible outside the premises after 9pm Sunday to Thursday and 10pm Friday to Saturday.

I would be most grateful if you could acknowledge receipt of this email and its contents.

Kind regards

Debra Paris

Planning and Licensing Committee Clerk Loughton Town Council

Loughton Library & Town Hall, Traps Hill, Loughton, IG10 1HD

Tel: 020 8508 4200

Fax: 020 8508 4400

E-mail [contact@loughton-tc.gov.uk](mailto:contact@loughton-tc.gov.uk)

Web: [www.loughton-tc.gov.uk](http://www.loughton-tc.gov.uk)

---

# Loughton Residents Association Plans Group

---



david.linnell@loughtonresidents.co.uk

01 August 2019

## **LICENSING APPLICATION, 12-14 The Broadway Loughton**

We object to this application on the basis of the prevention of public nuisance.

This restaurant has residential units above and nearby. Indeed, all the roads leading to and from the restaurant are residential, including Rectory Lane/ Chigwell Lane.

Under the provisions relating the prevention of public nuisance, we object to the proposal to vary the hours for the supply of alcohol and the provision of recorded music to 1am each night because of the disturbance this would inevitably cause to residents nearby.

We think that 11pm is the latest that restaurant with residential accommodation above should be providing alcohol and recorded music as, even if the premises are well-sound-proofed, the noise of such customers - and their vehicles - leaving late at night, at a time when other daytime noises are much reduced, would obviously disturb residents.

This would also set an unfortunate precedent for other licensed premises in The Broadway.

Yours sincerely

David Linnell, for LRA Plans Group.

6/8/19.  
your ref. WK/2019217662 [REDACTED] A. Durr,  
[REDACTED] The Broadway  
[REDACTED]

Re; Ext of hours.  
Efezade, 12-14 The Broadway, Loughton  
ESSEX. IG10 3ST,

I would like to strongly object to the extension of hours on the grounds of THE PREVENTION OF PUBLIC NUISANCE. I live opposite the premises and there is enough noise from Efezade already.

I have to get up for work at 3:00am. I am often kept awake from noise from premises as it is. I feel it is totally inappropriate and unfair for people living near Efezade.

Licensing  
Epping Forest District Council  
Civic offices  
323 High Street  
Epping  
CM16 4BZ



The ground I am submitting my application on are

- prevention of crime and disorder
- public safety
- the prevention of public nuisance and
- the protection of children from home

The Broadway is ordinarily loud but since Efezade has opened the noise has risen especially on a Friday and Saturday nights. In the weekday the sound is also loud and packing away equipment can go on until 11pm which is disturbing.

As you may not be aware the Broadway echoes and with drunk people it can become frightening especially for children.

[Redacted] evidence will be provided) and including the opening hours with the sale of alcohol to 1am will affect our life's dramatically which I am really concerned about.

On a few occasions there had been a live singer at Efezade which was so loud it was not acceptable and neither I nor my son slept until gone midnight as the packing away, people getting cabs, arguing etc. happens after the music has stopped until gone 2am! I have to be up for work and I honestly do not know how I would function!

Being on the Broadway is already loud and I am frightened for the well-being of myself not being able to sleep and getting up for work at 6am and also my son being able to concentrate in school.

My [Redacted] and I feel this will Interfere with [Redacted] future.

I feel this would encourage more bad behaviour on the Broadway, there are local drug takers that hang around outside Efezade and the license being open until 1am is not right for a residential area that echos!

I feel serving alcohol and live singers on a residential grounds where allot of children live and have to get up for school and work - is unfair.

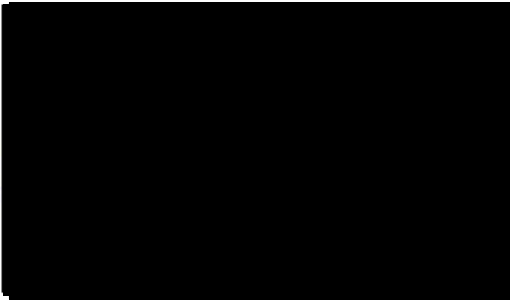

**Handan Ibrahim**

---

**From:** Riad Ebrahim [REDACTED]  
**Sent:** 26 August 2019 23:21  
**To:** Licensing  
**Cc:** Sumayyah Khonat  
**Subject:** Objection of application to vary premises licence in respect of Efezade, 12-14 The Broadway, Loughton, IG10 3ST

**CAUTION: This Message originated outside of Epping Forest District Council. Do not click links or open attachments unless you recognise the sender and know the contents is safe.**

---

Hello,

I am writing to strongly object the licensing application to vary the premises licence in respect of Efezade, 12-14 The Broadway, Loughton, IG10 3ST.

My reasons for objection are as follows:

- Page 80
1. Concerns of anti-social behaviour and increase in crime due to the licence of alcohol and late hours it is open.
  2. It is not in line with other commercial hours that are near residential areas
  3. Increase of litter e.g sick, cigarettes, drugs etc
  4. Noise/music pollution and disturbance that will disturb me and the residents during the night at unsociable hours. Our work/living will also be disturbed and affected.
  5. Safety of the residents and passer's by due to the late night opening hours and alcohol.
  6. Increased potential drug activity beyond the already present one in the area
  7. Smell pollution: smoking, food, sick, extra people
  8. Loitering at unsociable hours and increased traffic at late times (cabs/pickups etc.)

Yours faithfully,  
Riad Ebrahim



[REDACTED] The Broadway  
Loughton Essex  
[REDACTED]

20<sup>th</sup> August 2019

For the attention of the Licensing Team

Dear Sirs,

Re: Application WK/201921766 by Mr Erdogan, Elfezade Turkish Restaurant, 12 – 14 The Broadway, Loughton Essex IG10 3ST

We wish to make a representation.

[REDACTED] We wish to object to the extension of hours until 01.00hrs, 7 days a week under the prevention of public nuisance section of the Licensing Act 2003.

There is already a noise nuisance from the premises whilst it is open, and if the premises are allowed to play music any longer than 11pm then this would actually make life intolerable for us.

The premises do not, to my knowledge, have sound proofing or noise limiting devices. The building is old (1954) and made of solid concrete which amplifies sound. The building is not designed to contain modern levels of sound and vibration and the noise inevitably escapes from the premises and affects us.

During the day sounds from the restaurant are a nuisance but tolerable. We hear people singing, we hear banging noises (like someone is hammering a nail in the wall) which we think may be associated with the cutting up of meat. But at night, when it is quiet outside, when the music is turned up we have to keep the windows shut, turn up the television and avoid having guests at the weekend when noisy events are held.

We have in the past contacted the Enviromental team at the council (Mr Mark Richardson is very aware of the problem). We have complained in person to the manager on one occasion but were told that as he had a license to 11pm there was no obligation to turn the music down. And he didn't. We have also spoken to Mrs Tuckey (in charge of the Licensing Team) in person at the Council offices 10<sup>th</sup> (or maybe 17<sup>th</sup>) June who advised us to keep a diary and call the Council when there is a problem, and also told us that it is quite difficult to recind an applicaton once granted.

Another concern for us is that [REDACTED]

[REDACTED] In fact this flat is the most vulnerable to the noise [REDACTED]. The previous tenant made several complaints of noise nuisance to the council, kept a diary and spoke to the manager several times in person. She and her children were unable to sleep at times. [REDACTED] noise nuisance complaints being a factor in her move. Again Mr Richardson (Enviromental Services) can verify this as obviously he cannot let us have specific dates and times of her complaints.

The flats above the premises are large 3 bedroom properties, designed for families. The sounds vibrate up very, very clearly. The second flat [REDACTED] has young children.

I am not sure how the extended hours will affect local residents re anti-social noise and behaviour. We are subject to random shouting/bad behaviour at times as we are en route from Debden Station. At present I have to say that we have not witnessed any bad behaviour resulting from the restaurant.

It is the music noise reverberating through our home that most concerns us. It is bad enough when it goes on til 11pm. Please please do not extend the time.

Yours sincerely,

Mrs Paula Britz

Mr Karl Britz

This is the letter we sent for the first application in July (same ref. number)

[REDACTED]

**Handan Ibrahim**

---

**From:** Gavin Brill [REDACTED]  
**Sent:** 18 August 2019 14:17  
**To:** Licensing  
**Subject:** Efezade Turkish Restaurant

**CAUTION: This Message originated outside of Epping Forest District Council. Do not click links or open attachments unless you recognise the sender and know the contents is safe.**

I write in response to the proposed extension to the opening hours, sale of alcohol and for the permission to have live music.

I object to the request of the change in their business conditions as currently the business operates as a restaurant. By allowing them to extend their hours with the sale of alcohol and live music, this will attract the "riff raf" to the area with an increase in illegal parking especially after hours, cars stopping illegally to drop off and collect passengers, additional noise, people creating havoc in the roads and not to mention the noise pollution not only from the restaurant but also from the cars with loud music. All of this within a quiet and peaceful residential area. The additional noise and loitering will in no doubt lead to a decrease in property value in the area.

I also seriously doubt whether the roadways will be able to handle the traffic with illegal parking.

Regards  
Gavin Brill

[REDACTED]  
The Broadway

Handan Ibrahim

---

**From:** [REDACTED]  
**Sent:** 10 August 2019 14:47  
**To:** Licensing  
**Subject:** Attn Licensing Team - OBJECTION to extended hours: Efezade 12-14 The Broadway, Loughton, Essex, IG10 3ST

**CAUTION: This Message originated outside of Epping Forest District Council. Do not click links or open attachments unless you recognise the sender and know the contents is safe.**

---

To Whom it may concern,

Licensing Unit (01992) 564034

Efezade 12-14 The Broadway, Loughton, Essex, IG10 3ST

Application to vary premises licence to extend the hours until 01:00am for music and alcohol/late night refreshments.

I am writing as a Landmark House resident to **OBJECT** strongly to licensing applications for the above mentioned application, For the following reasons;

1. Noise/music pollution and disturbance from the proposed development that will disturb the residence during the night at unsociable hours.
2. Risk of creating a precedent with other establishments opening or already in the area.
3. Concerns of anti-social behaviour and increase of crime due to the licence of alcohol and late hours it is open
4. It is not in line with other commercial hours that are near residential areas
5. Increase in litter e.g. sick, cigarettes, drugs etc.
6. Safety of the residents and passer's by due to the late night opening hours and alcohol.
7. Increased potential drug activity beyond the already present one at the back of our property.
8. Smoking air pollution
9. Loitering at unsociable hours and increased traffic at late times (Cabs/pickups etc.)

To confirm I am rejecting on behalf of the 9 licensing objections – the prevention of crime and disorder, public safety, the prevention of public nuisance and the protection of children from harm.

Do not hesitate to contact me by email or by phone [REDACTED] should you wish to discuss this further.

With thanks and kind regards,  
James Tapfield

[REDACTED]  
The Broadway  
Loughton  
Essex  
[REDACTED]

## Denise Bastick

---

**From:** Dan Allisett <[REDACTED]>  
**Sent:** 08 August 2019 14:14  
**To:** Licensing  
**Subject:** Licence Objection - Efezade late night opening

**CAUTION: This Message originated outside of Epping Forest District Council. Do not click links or open attachments unless you recognise the sender and know the contents is safe.**

---

Good afternoon,

I am writing to **OBJECT** strongly to licensing applications for the extended operating hours for the Efezade restaurant in Loughton on the Debden Broadway.

This is almost certain to bring huge amounts of noise/music pollution and disturbance to the local residents during the night at unsociable hours. There was a late night event at the recently closed Green Owl and it was quite incredible how loud this was. I could hear lyrics to songs and constant thumping of bass from the music.

If this type of operation was allowed to return, it would have a hugely negative impact on the local area. I also fear for the increased risk in anti social behaviour from late night drinking. We've recently seen more active anti-social behaviour in the area via the rise in graffiti (including both Efezade itself and on Landmark House). This is something nobody wants to see reoccur, or indeed get worse.

My concerns and strong objection ultimately come down to how much it will affect the local residents, and this would be an unfair interference and hugely impact our comfort and enjoyment of our properties.

I look forward to hearing your thoughts.

Kind regards,  
Dan

## Denise Bastick

---

**From:** Jack Turner <[REDACTED]>  
**Sent:** 08 August 2019 12:09  
**To:** Licensing  
**Cc:** contact@loughtonresidents.co.uk; [REDACTED]  
**Subject:** Efezade Late License Application

**Importance:** High

**CAUTION: This Message originated outside of Epping Forest District Council. Do not click links or open attachments unless you recognise the sender and know the contents is safe.**

---

Good afternoon,

To whom it may concern, I am writing to OBJECT on behalf of myself and my partner to EFEZADE Turkish restaurants Debden Broadyway late license application.

As a resident in the area, I strongly object to the sale of alcohol for the times that have been presented as well as the license for later openings and live music to be played.

The points I would like to raise in objection to the application are:

1. Noise/music pollution and disturbance from the proposed development that will disturb me and the residents during the night at unsociable hours.
2. Risk of creating a precedent with other establishments opening or already in the area to have late licenses and create an atmosphere of a PARTY TOWN in our area
3. Concerns of anti-social behaviour and increase of crime due to the licence of alcohol and late hours it is open – I would like to note Devere road carpark is a HOTSPOT for Drug drops and Laughing gas purchasing already
4. It is not in line with other commercial hours that are near residential areas
5. Increase in litter e.g. sick, cigarettes, drugs etc.
6. Safety of the residents and passer's by due to the late night opening hours and alcohol.
7. Increased potential drug activity beyond the already present one at the back of our property. As stated above with Devere road car park
8. Smell pollution: Smoking, food, sick, extra people causing outdoor balconies to become unusable
9. Loitering at unsociable hours and increased traffic at late times (Cabs/pickups etc.)
10. Visually our visibility from the windows and balcony's will be compromised and affected by the increase of people and outdoor seating/furniture.

To confirm I am rejecting on behalf of the 10 licensing objections – the prevention of crime and disorder, public safety, the prevention of public nuisance and the protection of children from harm. It ultimately comes down to how much it will affect the residents, and this would be an unfair interference and hugely impact our comfort ability and enjoyment of our properties.

Best,

Jack Turner  
[REDACTED]

## Denise Bastick

---

**From:** Sam Norey [REDACTED]  
**Sent:** 08 August 2019 12:29  
**To:** Licensing  
**Subject:** Licensing Unit (01992) 564034 | Efezade 12-14 The Broadway, Loughton, Essex, IG10 3ST

**CAUTION: This Message originated outside of Epping Forest District Council. Do not click links or open attachments unless you recognise the sender and know the contents is safe.**

---

To Whom it may concern,

- Licensing Unit (01992) 564034
- Efezade 12-14 The Broadway, Loughton, Essex, IG10 3ST
- Application to vary premises licence to extend the hours until 01:00am for music and alcohol/late night refreshments.

This is firstly a "restaurant" not a club or bar. It is completely unnecessary to have the opening hours lengthened unless they are permitting to change the type of unit use? I would like to endeavour for the question to be raised "what reason does the license need to be extended?".

I have researched opening hours of the same type of establishments around the area; Turquoise in Loughton, Woodoven in South Woodford and Gosht in Buckhurst Hill and all close before 1am. This only reinstates that this application should be rejected.

I am writing as a Landmark House resident to **OBJECT** strongly to the licensing application stated above for the following reasons;

- Noise and disturbance from the proposed development that will disturb the residence during the night
- Risk of creating a precedent with other establishments opening
- Concerns of anti-social behaviour and increase of crime due to the licence of alcohol and late hours it is open
- It is not in line with other commercial hours that are near residential areas
- Increase in litter e.g. sick, cigarettes, drugs etc.
- Safety of the residents and passer's by due to the late night opening hours and alcohol
- Increased drug activity beyond the already present one at the back of our property
- Smoking air pollution

To confirm I am rejecting on behalf of the 8 licensing objections – the prevention of crime and disorder, public safety, the prevention of public nuisance and the protection of children from harm.

Thanks  
Sam



## Denise Bastick

---

**From:** Georgiou, Joanna [REDACTED]  
**Sent:** 08 August 2019 11:42  
**To:** Licensing  
**Subject:** Licensing Unit (01992) 564034 | Efezade 12-14 The Broadway, Loughton, Essex, IG10 3ST

**CAUTION: This Message originated outside of Epping Forest District Council. Do not click links or open attachments unless you recognise the sender and know the contents is safe.**

---

To Whom it may concern,

Licensing Unit (01992) 564034

- Efezade 12-14 The Broadway, Loughton, Essex, IG10 3ST
- Application to vary premises licence to extend the hours until 01:00am for music and alcohol/late night refreshments.

This is firstly a "restaurant" not a club or bar. It is completely unnecessary to have the opening hours lengthened unless they are permitting to change the type of unit use? I would like to endeavour for the question to be raised "what reason does the license need to be extended?".

I have researched opening hours of the same type of establishments around the area; Turquoise in Loughton, Woodoven in South Woodford and Gosht in Buckhurst Hill and all close before 1am. This only reinstates that this application should be rejected.

I am writing as a Landmark House resident to **OBJECT** strongly to the licensing application stated above for the following reasons;

- Noise and disturbance from the proposed development that will disturb the residence during the night
- Risk of creating a precedent with other establishments opening
- Concerns of anti-social behaviour and increase of crime due to the licence of alcohol and late hours it is open
- It is not in line with other commercial hours that are near residential areas
- Increase in litter e.g. sick, cigarettes, drugs etc.
- Safety of the residents and passer's by due to the late night opening hours and alcohol
- Increased drug activity beyond the already present one at the back of our property
- Smoking air pollution

To confirm I am rejecting on behalf of the 8 licensing objections – the prevention of crime and disorder, public safety, the prevention of public nuisance and the protection of children from harm.

Thanks  
Joanna

Joanna Georgiou [REDACTED]  
[REDACTED]

## Denise Bastick

---

**From:** Ella [REDACTED]  
**Sent:** 08 August 2019 08:36  
**To:** Handan Ibrahim; Licensing  
**Cc:** Denise Bastick  
**Subject:** Attn Licensing Team - OBJECTION to extended hours: Efezade 12-14 The Broadway, Loughton, Essex, IG10 3ST

**CAUTION: This Message originated outside of Epping Forest District Council. Do not click links or open attachments unless you recognise the sender and know the contents is safe.**

---

To Whom it may concern,

Licensing Unit (01992) 564034

Efezade 12-14 The Broadway, Loughton, Essex, IG10 3ST

Application to vary premises licence to extend the hours until 01:00am for music and alcohol/late night refreshments.

I am writing as a Landmark House resident to **OBJECT** strongly to licensing applications for the above mentioned application, For the following reasons;

1. Noise/music pollution and disturbance from the proposed development that will disturb the residence during the night at unsociable hours.
2. Risk of creating a precedent with other establishments opening or already in the area.
3. Concerns of anti-social behaviour and increase of crime due to the licence of alcohol and late hours it is open
4. It is not in line with other commercial hours that are near residential areas
5. Increase in litter e.g. sick, cigarettes, drugs etc.
6. Safety of the residents and passer's by due to the late night opening hours and alcohol.
7. Increased potential drug activity beyond the already present one at the back of our property.
8. Smoking air pollution
9. Loitering at unsociable hours and increased traffic at late times (Cabs/pickups etc.)

To confirm I am rejecting on behalf of the 9 licensing objections – the prevention of crime and disorder, public safety, the prevention of public nuisance and the protection of children from harm. Nothing should be granted that will be an inconvenience to residents and affect their use and living in their home.

Please also find below a petition from Landmark House displaying the support of this rejection.

Do not hesitate to contact me by email or by phone [REDACTED] should you wish to discuss this further.

With thanks and kind regards,  
Miss Ella Gershon

[REDACTED]  
The Broadway  
Loughton  
Essex  
[REDACTED]

## NOTIFICATION

Dear Landmark Residents,

You may have received an application letter through about Efezade applying to extend their opening hours for music, alcohol and late night refreshments until 01:00am – 7 days a week!

I am writing as a Landmark House resident to **OBJECT** strongly to licensing applications for the above mentioned application, For the following reasons;

1. Noise/music pollution and disturbance from the proposed development that will disturb the residence during the night at unsociable hours.
2. Risk of creating a precedent with other establishments opening or already in the area.
3. Concerns of anti-social behaviour and increase of crime due to the licence of alcohol and late hours it is open
4. It is not in line with other commercial hours that are near residential areas
5. Increase in litter e.g. sick, cigarettes, drugs etc.
6. Safety of the residents and passer's by due to the late night opening hours and alcohol.
7. Increased potential drug activity beyond the already present one at the back of our property.
8. Smoking air pollution
9. Loitering at unsociable hours and increased traffic at late times (Cabs/pickups etc.)

Along with other residents who are also strongly opposing this. As a community, our petition last time was one of the main reasons for support from the council.

We need your help again to get even more traction by signing our petition that you all so kindly supported last time. If you would like to support this application rejection, please kindly fill in your details below & also we encourage you to email the licencing team with your own rejection letter.

Name	Flat Number	Signature
Ella Gershon		
S. KHONAT		
J. Chaplin		
H. Baker		
R. TURANO		
<del>XXXXXXXXXX</del>		
A. Hocher		
J. Turner		
L. Blackwell		
S. Jdel		
T. Brys		
S. Norey		
J. Georgiou		
H. Samson		
G. Hayward		
A. BREWER		
M. HUTCHINSON		
J. Fieldhouse		
J. WHITAKER		
K. Bolton		
N. Wilkins		
Gavin Billo		
V. MARTINEZ		
S. AFZAL		

Name	Flat Number	Signature
Ella Gerison		
Dan Allisett		
Alex Elton		
LORRINO KOLIKARI		
Jacob Stevens		
Mira Rastas		
FURUK AKAR		
David Stitt		
S. Khonant		
P. Carr		
S. Reid		
Omer I		
ADAM JARVES		
C. Monahan		
C. THOMAS		
A Tempest Hees		
Loughfarthing		
TOMIWIN		
EMILY HERBERT		
S. Gaddard		
S. B. W. M.		

T Cook

D. KAUTHI

Maria ~~Malay~~ <sup>Malay</sup> ~~grani~~

Ray Balw

XOX A

M. Mulex

SBunk

N. BEM

NEUNDERSON

## Denise Bastick

---

**From:** Claire Thomas <[REDACTED]>  
**Sent:** 07 August 2019 18:35  
**To:** Licensing  
**Subject:** Opposition to extension of hours

CAUTION: This Message originated outside of Epping Forest District Council. Do not click links or open attachments unless you recognise the sender and know the contents is safe.

I am writing to oppose the extension of licensing hours for the premises: Efezade, 12-14 The Broadway, Loughton, Essex.

I believe it is unnecessary for it to be open so late in a quiet residential area. I have already been disturbed by loud music and people at the current hours, I do not want to hear this disturbance even later.

Please take this as my strong opposition.

Thanks

Claire Thomas  
[REDACTED]

Sent from my iPhone



Handan Ibrahim

---

**From:** Sophie Goddard [REDACTED]  
**Sent:** 06 August 2019 14:44  
**To:** Licensing  
**Subject:** Representation - register of licence - Efezaf 12 to 14 the Broadway

**CAUTION: This Message originated outside of Epping Forest District Council. Do not click links or open attachments unless you recognise the sender and know the contents is safe.**

---

Hi

I am getting in touch as would like to reject the register for extension to licence application. The extended hours will exaggerate the noise pollution and create a number of issues which could impact detrimentally on my ability to live where I do. Please can you get in touch with what I should do to follow this up. The letter I received contains little guidance on what should be included.

Kind regards

Sophie Goddard  
[REDACTED]

Get [Outlook for iOS](#)

The Licensing Team  
Epping Forest District Council  
Civic Offices  
323 High Street  
Essex CM16 4BZ  
Attention Mrs Ibrahim, Officer in charge

5<sup>th</sup> August 2019

Dear Mrs Ibrahim,

**Licensing Application – Efezade 12-14 The Broadway, Loughton, Essex IG10 3ST**

Thank you for your letter dated 1 August, 2019 informing of the application regarding the vary premises license to extend hours.

I wish to raise objections on the grounds of preventing public nuisance through excessive noise and disruption at unsocial hours arising from the proposed extended licensing hours.

By way of context, my daughter, [REDACTED] lives in one of the flats [REDACTED] [REDACTED]. The property overlooks [REDACTED] which will be used by customers of Efezade once they leave the premises in the early hours. [REDACTED] and spaces will be directly impacted through the milling around and noise and unsocial behaviour late into the night.

We understand the desire to extend licensing hours on a Friday and Saturday night, and have no objection to this being granted, but see no justification whatsoever to permit extended licensing beyond the current agreed hours of 11.00 pm on Monday to Thursday and past 10.00 pm on Sundays. The area is not serviced by night clubs and other establishments that warrant the late night services of the type proposed.

While we have no objection to Efezade continuing its operations in a controlled manner, we have a significant concern that this would be establish an unhealthy precedent which, once granted cannot be pulled back. Rather than attracting favourable clientele in a family friendly environment, this would attract an unwelcome customer base that has little regard for the wellbeing of neighbours with associated noise and disturbance.

We are concerned that noise levels and will be excessive adversely impacting the surrounding properties, including our own. We would not be able to open windows, especially in the summer months.

The Broadway is a safe environment with a large amount of residential property nearby and it is not unreasonable to contain the licensing hours to ensure the current ambience is not disturbed.

Thank you for your kind consideration.

Yours faithfully

William Hayward

[REDACTED]  
Loughton [REDACTED]

**Handan Ibrahim**

---

**From:** Donna [REDACTED]  
**Sent:** 03 August 2019 14:23  
**To:** Licensing  
**Subject:** Ref WK/201921766

**CAUTION:** This Message originated outside of Epping Forest District Council. Do not click links or open attachments unless you recognise the sender and know the contents is safe.

I am writing to you in respect of an application submitted by Mr Erdogan of Efezade 12-14 The Broadway, Loughton, Essex IG10 3ST. My feelings on the matter of the licensing application are thus:

1. I would consent to music and alcohol licensing until 0100hrs on Fridays and Saturdays only and until 2300hrs the rest of the week.
2. The premises are located within a residential area where there are office workers and small children.
3. The current traffic situation late at night following the recent road works is difficult enough to endure, with cars racing up and down The Broadway and Chigwell Lane, without further enticement from a restaurant serving alcohol into the small hours.
4. The Broadway is a valley of 3 storey buildings which enhances sounds from cars and shops, and would exacerbate loud music at night.

As the application is currently submitted, I am against the application, however I feel that if my suggested amendments are made, a favourable agreement can be reached.

Kind regards

Donna Cater

**Handan Ibrahim**

---

**From:** Contact Planning  
**Sent:** 31 July 2019 16:41  
**To:** Handan Ibrahim  
**Cc:** Michael Johnson  
**Subject:** RE: Re: Application to vary premises licence for Efezade, 12-14 The Broadway, Loughton, Essex, IG10 3ST, Reference: WK/201921766

Dear Handan, the approval for the change of use (EPF/3136/16) to A3 on this property has a condition that restricts the opening hours for member of the public until 23.00, they will need to apply for a Variation to this condition before operating longer opening hours, this will need to go through the 8 week planning process and a neighbour notification consultation. Opening outside of 23.00 pm will be in breach of this consent.

Kind Regards

Theresa Parker  
Senior Technical Officer  
01977 564476

\* Please do not print this email unnecessarily.

For further information regarding Planning Directorate please go to <https://www.eppingforestdc.gov.uk>

(Our reception opening times are now: 9:00am - 11:30am)

---

**From:** Handan Ibrahim  
**Sent:** 31 July 2019 09:35  
**To:** 'Michael Owen'; 'Cllr Chris Pond'; Cllr.G Mohindra; Brian Stalabrax; Enviroment Agency; Essex Fire & Rescue Service ; Essex Police HUB; Head Of Child Protection (licenceapplications@essex.gov.uk); Health & Safety Executive (Richard.Young@hse.gov.uk); Licensing Administration- Public Health ; The Home Office ; Trading Standards (Trading.Standards@essex.gov.uk); Christopher Smith; Contact Planning  
**Cc:** Denise Bastick  
**Subject:** RE: Re: Application to vary premises licence for Efezade, 12-14 The Broadway, Loughton, Essex, IG10 3ST, Reference: WK/201921766

Dear Colleagues,

Please find attached an application to vary the premises licence for the above premises.

Please note this application was originally submitted on the 3<sup>rd</sup> Jul 2019 but was later cancelled due to the applicant not advertising the variation request. The 2003 Act requires the applicant to advertise the application for a period of not less than 28 consecutive days starting on the day after the day on which the application was given.

This application is exactly the same as the original application which was submitted on 3<sup>rd</sup> July 2019.

The applicant would like to extend the sale of late night refreshment, the sale of alcohol, the hours the premises will be open to the public and include recorded music Monday to Sunday till 01:00am. The premises is

**Hours premises will be open to the public**

**Monday to Sunday 07:30am- 01:00am**

**The licensable activity applied for:**

**Supply of Alcohol: Both ( indoors and outdoors )**

**Monday to Sunday 10:00am- 01:00am**

**Late Night Refreshment (indoors )**

**Monday to Sunday 23:00pm – 01:00am**

**Recorded Music (indoors)**

**Monday to Sunday 10:00am-01:00am**

Please note that I have attached an unredacted copy of the application, premises licence which contains personal and sensitive information; Therefore this is not for public viewing.

Finally, Councillor Michael Owen, Councillor Chris Pond and County Councillor Gagan Mohindra have also been included as interested parties.

The start date of the consultation is **1<sup>st</sup> August 2019**, end of consultation will be **28<sup>th</sup> August 2019**. Please let me have any comments or objections by then.

Thank you

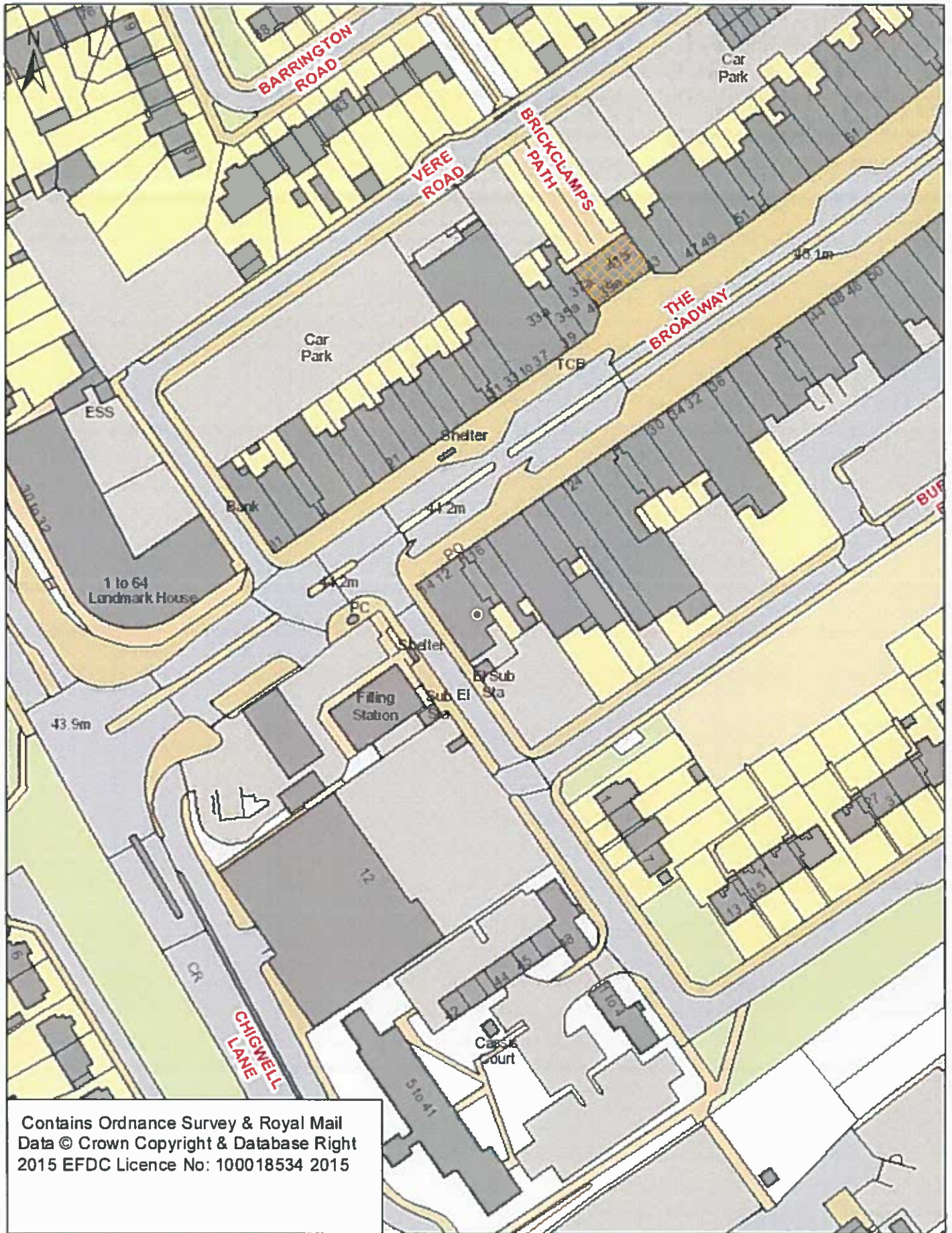

Contains Ordnance Survey & Royal Mail  
Data © Crown Copyright & Database Right  
2015 EFDC Licence No: 100018534 2015

## **Report to the Licensing Sub-Committee**

**Date of meeting: 17 September 2019**



**Epping Forest  
District Council**

**Subject:** Application for Premises Licence - Harlow Garden Centre, Canes Lane, Hastingwood

**Responsible Officer:** D. Houghton (01992) 564336))

**Democratic Services Officer:** S. Tautz (01992) 564180))

---

### **Decisions Required:**

**To consider an application for a Premises Licence under the Licensing Act 2003, with regard to Harlow Garden Centre, Canes Lane, Hastingwood.**

### **Application**

1. An application has been made by Blue Diamond UK Ltd, for a new premises licence for Harlow Garden Centre, Canes Lane, Hastingwood. The application is for the following licensing activities:
  - (a) the sale by retail of alcohol on the premises only from Monday to Saturday from 08.30 to 18.00 and Sunday from 10.00 to 16.30;
  - (b) the opening times of the premises are from Monday to Saturday from 08.30 to 18.00 and Sunday from 10.00 to 16.30.
2. The application was received on the 8 August 2019 and is attached as an appendix to this report, together with a plan of the premises.
3. The Operating Schedule sets out conditions which will be attached to the licence if this application is granted.

### **Licensing Act 2003**

4. When considering an application for a licence, the licensing authority must have regard to steps that are appropriate to the promotion of the licensing objectives. These are:
  - (a) the prevention of crime and disorder;
  - (b) public safety;
  - (c) the prevention of public nuisance; and
  - (d) the protection of children from harm.
5. The licensing authority must also have regard to its Statement of Licensing Policy and any guidance issued by the Secretary of State.

### **Consultation**

6. The responsible authorities have all been consulted with regard to the application, which was also advertised at the premises and in a local newspaper. A copy of the public notice and newspaper publication is also attached to this report.

7. All residences and businesses within a radius of 150 metres of the premises have been individually consulted on the application. The Council has received a representation from North Weald Bassett Parish Council with regard to the application, which is also attached to this report. The objection relates to the prevention of public nuisance and public safety
8. Essex Police have made no representations in respect of the application, as recommended conditions have been agreed between both parties. These are also attached to this report.

### **Guidance Issued by the Secretary of State**

9. The Licensing Act 2003 provides that the licensing authority must 'have regard to' guidance issued by the Secretary of State under Section 182 of the Act. Sections 2.15 to 2.21 of the Guidance are relevant to this application.

### **Options**

10. In determining the application, the Sub-Committee may take any of the following steps as it considers necessary for the promotion of the licensing objectives, namely:
  - (a) to grant the licence as applied for subject to:
    - (i) the conditions mentioned in the Operating Schedule modified as the Sub-committee considers necessary for the promotion of the licensing objectives, and
    - (ii) the mandatory conditions specified in the Licensing Act 2003, or
  - (b) to exclude from the scope of the licence any licensable activities to which the application relates, or
  - (c) to refuse to specify a person as the premises supervisor, or
  - (d) to reject the application.

### **Determination**

11. The Sub-committee is asked to determine the application having regard to
  - (a) the content of this report and representations;
  - (b) any additional information obtained from the hearing;
  - (c) the Council's statement of licensing policy;
  - (d) guidance issued by the Secretary of State, and
  - (e) the steps appropriate to promote the licensing objectives.

### **Appeal**

12. If any party is aggrieved with the decision of the Sub-Committee with regard to the application, they can appeal to the Magistrates Court. The appeal period is twenty-one days from the notification of the decision.

### **Background papers used in the preparation of this report:**

- the Licensing Act 2003:  
<http://www.legislation.gov.uk/ukpga/2003/17/contents?view=plain>
- the Secretary of State's Guidance issued under Section 182 of the Licensing Act 2003; and
- Epping Forest District Council's statement of licensing policy  
<http://www.eppingforestdc.gov.uk>



**Attached documents**

- application for premises licence;
- plan of the premises;
- newspaper publication and public notice;
- map of area;
- copy of representation from North Weald Bassett Parish Council; and
- copy of representation from Essex Police.

This page is intentionally left blank

**Application for a premises licence to be granted under the Licensing Act 2003**

**PLEASE READ THE FOLLOWING INSTRUCTIONS FIRST**

Before completing this form please read the guidance notes at the end of the form. If you are completing this form by hand please write legibly in block capitals. In all cases ensure that your answers are inside the boxes and written in black ink. Use additional sheets if necessary.

You may wish to keep a copy of the completed form for your records.

I/We Blue Diamond UK Limited

*(Insert name(s) of applicant)*

apply for a premises licence under section 17 of the Licensing Act 2003 for the premises described in Part 1 below (the premises) and I/we are making this application to you as the relevant licensing authority in accordance with section 12 of the Licensing Act 2003

**Part 1 – Premises details**

Postal address of premises or, if none, ordnance survey map reference or description			
Harlow Garden Centre Canes Lane Hastingwood Nr Harlow			
Post town	Essex	Postcode	CM17 9LD
Telephone number at premises (if any)			
Non-domestic rateable value of premises		£188,000	

**Part 2 - Applicant details**

Please state whether you are applying for a premises licence as

Please tick as appropriate

- |  |                          |                             |
|--|--------------------------|-----------------------------|
| a) an individual or individuals *                    | <input type="checkbox"/> | please complete section (A) |
| b) a person other than an individual *               |                          |                             |
| i as a limited company/limited liability partnership | X                        | please complete section (B) |
| ii as a partnership (other than limited liability)   | <input type="checkbox"/> | please complete section (B) |
| iii as an unincorporated association or              | <input type="checkbox"/> | please complete section (B) |
| iv other (for example a statutory corporation)       | <input type="checkbox"/> | please complete section (B) |
| c) a recognised club                                 | <input type="checkbox"/> | please complete section (B) |
| d) a charity   | <input type="checkbox"/> | please complete section (B) |
| e) the proprietor of an educational establishment    | <input type="checkbox"/> | please complete section (B) |
| f) a health service body                             | <input type="checkbox"/> | please complete section (B) |

- g) a person who is registered under Part 2 of the Care Standards Act 2000 (c14) in respect of an independent hospital in Wales  please complete section (B)
- ga) a person who is registered under Chapter 2 of Part 1 of the Health and Social Care Act 2008 (within the meaning of that Part) in an independent hospital in England  please complete section (B)
- h) the chief officer of police of a police force in England and Wales  please complete section (B)

\* If you are applying as a person described in (a) or (b) please confirm (by ticking yes to one box below):

I am carrying on or proposing to carry on a business which involves the use of the premises for licensable activities; or

I am making the application pursuant to a statutory function or

a function discharged by virtue of Her Majesty's prerogative

**(A) INDIVIDUAL APPLICANTS** (fill in as applicable)

<input type="checkbox"/> Mr	<input type="checkbox"/> Mrs	<input type="checkbox"/> Miss	<input type="checkbox"/> Ms	Other Title (for example, Rev)	
Surname			First names		
Date of birth		I am 18 years old or over <input type="checkbox"/>		Please tick yes	
Nationality					
Current residential address if different from premises address					
Post town				Postcode	
Daytime contact telephone number					
E-mail address (optional)					
Where applicable (if demonstrating a right to work via the Home Office online right to work checking service), the 9-digit 'share code' provided to the applicant by that service (please see note 15 for information)					

**SECOND INDIVIDUAL APPLICANT (if applicable)**

Mr <input type="checkbox"/>	Mrs <input type="checkbox"/>	Miss <input type="checkbox"/>	Ms <input type="checkbox"/>	Other Title (for example, Rev)	
Surname			First names		
Date of birth		I am 18 years old or over		<input type="checkbox"/> Please tick yes	
Nationality					
Where applicable (if demonstrating a right to work via the Home Office online right to work checking service), the 9-digit 'share code' provided to the applicant by that service: (please see note 15 for information)					
Current residential address if different from premises address					
Post town		Postcode			
Daytime contact telephone number					
E-mail address (optional)					

**(B) OTHER APPLICANTS**

Please provide name and registered address of applicant in full. Where appropriate please give any registered number. In the case of a partnership or other joint venture (other than a body corporate), please give the name and address of each party concerned.

Name Blue Diamond UK Limited
Address Bambridge Park Garden Centre Kiln Lane Eastleigh Hampshire SO50 6HT
Registered number (where applicable) 2421720
Description of applicant (for example, partnership, company, unincorporated association etc.) Limited Company
Telephone number (if any)
E-mail address (optional)

**Part 3 Operating Schedule**

When do you want the premises licence to start?

DD	MM	YYYY
0	4	09 2 0 1 9

If you wish the licence to be valid only for a limited period, when do you want it to end?

DD	MM	YYYY

Please give a general description of the premises (please read guidance note 1)

These premises trade as an established garden centre with indoor and outdoor retail sales areas. The Tea Room offers hot and cold food throughout the day and an outside terrace is available for customers use in good weather.

Off sales of alcohol are planned from the covered retail shop floor and consumption of alcohol is anticipated in the restaurant and outside terrace.

The layout of the premises is shown on the plan provided with the area to be licensed outlined in red.

If 5,000 or more people are expected to attend the premises at any one time, please state the number expected to attend.

What licensable activities do you intend to carry on from the premises?

(please see sections 1 and 14 and Schedules 1 and 2 to the Licensing Act 2003)

Provision of regulated entertainment (please read guidance note 2)

Please tick all that apply

- a) plays (if ticking yes, fill in box A)
- b) films (if ticking yes, fill in box B)
- c) indoor sporting events (if ticking yes, fill in box C)
- d) boxing or wrestling entertainment (if ticking yes, fill in box D)
- e) live music (if ticking yes, fill in box E)
- f) recorded music (if ticking yes, fill in box F)
- g) performances of dance (if ticking yes, fill in box G)
- h) anything of a similar description to that falling within (e), (f) or (g) (if ticking yes, fill in box H)

Provision of late night refreshment (if ticking yes, fill in box I)

Supply of alcohol (if ticking yes, fill in box J)

X

In all cases complete boxes K, L and M

**A**

<b>Plays</b> Standard days and timings (please read guidance note 7)			<b>Will the performance of a play take place indoors or outdoors or both – please tick</b> (please read guidance note 3)	Indoors	<input type="checkbox"/>			
				Outdoors	<input type="checkbox"/>			
				Both	<input type="checkbox"/>			
Day	Start	Finish	<b>Please give further details here</b> (please read guidance note 4)					
Mon								
Tue								
Wed						<b>State any seasonal variations for performing plays</b> (please read guidance note 5)		
Thur								
Fri						<b>Non standard timings. Where you intend to use the premises for the performance of plays at different times to those listed in the column on the left, please list</b> (please read guidance note 6)		
Sat								
Sun								

**B**

<b>Films</b> Standard days and timings (please read guidance note 7)			<b>Will the exhibition of films take place indoors or outdoors or both – please tick</b> (please read guidance note 3)	Indoors	<input type="checkbox"/>			
				Outdoors	<input type="checkbox"/>			
				Both	<input type="checkbox"/>			
Day	Start	Finish	<b>Please give further details here</b> (please read guidance note 4)					
Mon								
Tue								
Wed						<b>State any seasonal variations for the exhibition of films</b> (please read guidance note 5)		
Thur								
Fri						<b>Non standard timings. Where you intend to use the premises for the exhibition of films at different times to those listed in the column on the left, please list</b> (please read guidance note 6)		
Sat								
Sun								

C

<b>Indoor sporting events</b> Standard days and timings (please read guidance note 7)			<u>Please give further details</u> (please read guidance note 4)
Day	Start	Finish	
Mon			<u>State any seasonal variations for indoor sporting events</u> (please read guidance note 5)
Tue			
Wed			
Thur			<u>Non standard timings. Where you intend to use the premises for indoor sporting events at different times to those listed in the column on the left, please list</u> (please read guidance note 6)
Fri			
Sat			
Sun			

D

<b>Boxing or wrestling entertainments</b> Standard days and timings (please read guidance note 7)			<u>Will the boxing or wrestling entertainment take place indoors or outdoors or both – please tick</u> (please read guidance note 3)	
Day	Start	Finish	Indoors	<input type="checkbox"/>
			Outdoors	<input type="checkbox"/>
			Both	<input type="checkbox"/>
Mon			<u>Please give further details here</u> (please read guidance note 4)	
Tue				
Wed			<u>State any seasonal variations for boxing or wrestling entertainment</u> (please read guidance note 5)	
Thur				
Fri				
Sat			<u>Non standard timings. Where you intend to use the premises for boxing or wrestling entertainment at different times to those listed in the column on the left, please list</u> (please read guidance note 6)	
Sun				



**E**

<b>Live music</b> Standard days and timings (please read guidance note 7)			<b>Will the performance of live music take place indoors or outdoors or both – please tick</b> (please read guidance note 3)	Indoors	<input type="checkbox"/>
				Outdoors	<input type="checkbox"/>
				Both	<input type="checkbox"/>
Day	Start	Finish			
Mon			<b>Please give further details here</b> (please read guidance note 4)		
Tue					
Wed			<b>State any seasonal variations for the performance of live music</b> (please read guidance note 5)		
Thur					
Fri			<b>Non standard timings. Where you intend to use the premises for the performance of live music at different times to those listed in the column on the left, please list</b> (please read guidance note 6)		
Sat					
Sun					

**F**

<b>Recorded music</b> Standard days and timings (please read guidance note 7)			<b>Will the playing of recorded music take place indoors or outdoors or both – please tick</b> (please read guidance note 3)	Indoors	<input type="checkbox"/>
				Outdoors	<input type="checkbox"/>
				Both	<input type="checkbox"/>
Day	Start	Finish			
Mon			<b>Please give further details here</b> (please read guidance note 4)		
Tue					
Wed			<b>State any seasonal variations for the playing of recorded music</b> (please read guidance note 5)		
Thur					
Fri			<b>Non standard timings. Where you intend to use the premises for the playing of recorded music at different times to those listed in the column on the left, please list</b> (please read guidance note 6)		
Sat					
Sun					

**G**

<b>Performances of dance</b> Standard days and timings (please read guidance note 7)			<b><u>Will the performance of dance take place indoors or outdoors or both – please tick</u></b> (please read guidance note 3)	Indoors	<input type="checkbox"/>
				Outdoors	<input type="checkbox"/>
				Both	<input type="checkbox"/>
<b>Day</b>	<b>Start</b>	<b>Finish</b>			
Mon			<b><u>Please give further details here</u></b> (please read guidance note 4)		
Tue					
Wed			<b><u>State any seasonal variations for the performance of dance</u></b> (please read guidance note 5)		
Thur					
Fri			<b><u>Non standard timings. Where you intend to use the premises for the performance of dance at different times to those listed in the column on the left, please list</u></b> (please read guidance note 6)		
Sat					
Sun					

**H**

<b>Anything of a similar description to that falling within (e), (f) or (g)</b> Standard days and timings (please read guidance note 7)			Please give a description of the type of entertainment you will be providing		
<b>Day</b>	<b>Start</b>	<b>Finish</b>	<b><u>Will this entertainment take place indoors or outdoors or both – please tick</u></b> (please read guidance note 3)	Indoors	<input type="checkbox"/>
Mon				Outdoors	<input type="checkbox"/>
				Both	<input type="checkbox"/>
Tue			<b><u>Please give further details here</u></b> (please read guidance note 4)		
Wed					
Thur			<b><u>State any seasonal variations for entertainment of a similar description to that falling within (e), (f) or (g)</u></b> (please read guidance note 5)		
Fri					
Sat			<b><u>Non standard timings. Where you intend to use the premises for the entertainment of a similar description to that falling within (e), (f) or (g) at different times to those listed in the column on the left, please list</u></b> (please read guidance note 6)		
Sun					

**I**

<b>Late night refreshment</b> Standard days and timings (please read guidance note 7)			<b>Will the provision of late night refreshment take place indoors or outdoors or both – please tick</b> (please read guidance note 3)	Indoors				
				Outdoors	<input type="checkbox"/>			
				Both	<input type="checkbox"/>			
<b>Day</b>	<b>Start</b>	<b>Finish</b>	<b>Please give further details here</b> (please read guidance note 4)					
Mon								
Tue								
Wed						<b>State any seasonal variations for the provision of late night refreshment</b> (please read guidance note 5)		
Thur								
Fri								
Sat						<b>Non standard timings. Where you intend to use the premises for the provision of late night refreshment at different times, to those listed in the column on the left, please list</b> (please read guidance note 6)		
Sun								

**J**

<b>Supply of alcohol</b> Standard days and timings (please read guidance note 7)			<b>Will the supply of alcohol be for consumption – please tick</b> (please read guidance note 8)	On the premises				
				Off the premises	<input type="checkbox"/>			
				Both	<input checked="" type="checkbox"/>			
<b>Day</b>	<b>Start</b>	<b>Finish</b>	<b>State any seasonal variations for the supply of alcohol</b> (please read guidance note 5)					
Mon	08.30	18.00						
Tue	08.30	18.00						
Wed	08.30	18.00				<b>Non standard timings. Where you intend to use the premises for the supply of alcohol at different times to those listed in the column on the left, please list</b> (please read guidance note 6)		
Thur	08.30	18.00						
Fri	08.30	18.00						
Sat	08.30	18.00						
Sun	10.00	16.30						

State the name and details of the individual whom you wish to specify on the licence as designated premises supervisor (Please see declaration about the entitlement to work in the checklist at the end of the form):

Name		[REDACTED]
Date of birth		
Address		
[REDACTED]		
Postcode	[REDACTED]	
Personal licence number (if known)		
[REDACTED]		
Issuing licensing authority (if known)		
[REDACTED]		

**K**

<p>Please highlight any adult entertainment or services, activities, other entertainment or matters ancillary to the use of the premises that may give rise to concern in respect of children (please read guidance note 9). None</p>
---

**L**

<p>Hours premises are open to the public Standard days and timings (please read guidance note 7)</p>			<p>State any seasonal variations (please read guidance note 5)</p>
Day	Start	Finish	
Mon	08.30	18.00	
Tue	08.30	18.00	
Wed	08.30	18.00	
Thur	08.30	18.00	
Fri	08.30	18.00	
Sat	08.30	18.00	
Sun	10.00	16.30	
			<p><b>Non standard timings. Where you intend the premises to be open to the public at different times from those listed in the column on the left, please list (please read guidance note 6)</b></p>

## M

Describe the steps you intend to take to promote the four licensing objectives:

**a) General – all four licensing objectives (b, c, d and e) (please read guidance note 10)**

The premises license holder, or the person appointed to be in charge of the premises when licensable activity is taking place, shall provide or have the unhampered use of a telephone on the premises for use in an emergency.

**b) The prevention of crime and disorder**

Alcohol shall not be sold in an open container by way of off sales

A written incident record shall be maintained at the premises to record all incidents in respect to crime and disorder. The incident record shall be available to Police upon request

The Licensee shall maintain an efficient closed circuit television (CCTV) surveillance system to the satisfaction of the Police Licensing Department. The CCTV shall include camera coverage of the alcohol display area as well as the entrances and exits.

A suitably worded sign of sufficient size and clarity shall be displayed at the entrance to the premises and in the alcohol display area, advising patrons that CCTV is operating within the premises.

**c) Public safety**

The applicants will ensure that all fire safety and other safety equipment is properly maintained.

**d) The prevention of public nuisance**

**e) The protection of children from harm**

The Licensee shall operate a "Challenge 25" scheme on the premises whereby those persons attempting to buy alcohol who appear to be under 25 years of age will be required to prove they are 18 years of age or older. Acceptable proof of age shall consist of passport, photographic driving licence or proof of age cards with the "PASS" logo.

The Licensee shall ensure that all staff are adequately trained on age identification.

Written staff training records for all staff engaged in the sale of alcohol shall be maintained by the licensee and retained on the premises.

Checklist:

Please tick to indicate agreement

- I have made or enclosed payment of the fee. X
- I have enclosed the plan of the premises. X
- I have sent copies of this application and the plan to responsible authorities and others where applicable.
- I have enclosed the consent form completed by the individual I wish to be designated premises supervisor, if applicable. X
- I understand that I must now advertise my application. X
- I understand that if I do not comply with the above requirements my application will be rejected. X
- [Applicable to all individual applicants, including those in a partnership which is not a limited liability partnership, but not companies or limited liability partnerships] I have included documents demonstrating my entitlement to work in the United Kingdom or my share code issued by the Home Office online right to work checking service (please read note 15).

**IT IS AN OFFENCE, UNDER SECTION 158 OF THE LICENSING ACT 2003, TO MAKE A FALSE STATEMENT IN OR IN CONNECTION WITH THIS APPLICATION. THOSE WHO MAKE A FALSE STATEMENT MAY BE LIABLE ON SUMMARY CONVICTION TO A FINE OF ANY AMOUNT.**

**IT IS AN OFFENCE UNDER SECTION 24B OF THE IMMIGRATION ACT 1971 FOR A PERSON TO WORK WHEN THEY KNOW, OR HAVE REASONABLE CAUSE TO BELIEVE, THAT THEY ARE DISQUALIFIED FROM DOING SO BY REASON OF THEIR IMMIGRATION STATUS. THOSE WHO EMPLOY AN ADULT WITHOUT LEAVE OR WHO IS SUBJECT TO CONDITIONS AS TO EMPLOYMENT WILL BE LIABLE TO A CIVIL PENALTY UNDER SECTION 15 OF THE IMMIGRATION, ASYLUM AND NATIONALITY ACT 2006 AND PURSUANT TO SECTION 21 OF THE SAME ACT, WILL BE COMMITTING AN OFFENCE WHERE THEY DO SO IN THE KNOWLEDGE, OR WITH REASONABLE CAUSE TO BELIEVE, THAT THE EMPLOYEE IS DISQUALIFIED.**

**Part 4 – Signatures (please read guidance note 11)**

**Signature of applicant or applicant’s solicitor or other duly authorised agent (see guidance note 12). If signing on behalf of the applicant, please state in what capacity.**

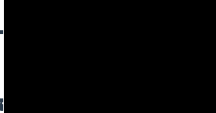
<b>Declaration</b>	<ul style="list-style-type: none"> <li>• [Applicable to individual applicants only, including those in a partnership which is not a limited liability partnership] I understand I am not entitled to be issued with a licence if I do not have the entitlement to live and work in the UK (or if I am subject to a condition preventing me from doing work relating to the carrying on of a licensable activity) and that my licence will become invalid if I cease to be entitled to live and work in the UK (please read guidance note 15).</li> <li>• The DPS named in this application form is entitled to work in the UK (and is not subject to conditions preventing him or her from doing work relating to a licensable activity) and I have seen a copy of his or her proof of entitlement to work, or have conducted an online right to work check using the Home Office online right to work checking service which confirmed their right to work (please see note 15)</li> </ul>
<b>Signature</b>	 Karen Pownall
<b>Date</b>	07/08/2019
<b>Capacity</b>	Authorised Agent

**For joint applications, signature of 2<sup>nd</sup> applicant or 2<sup>nd</sup> applicant’s solicitor or other authorised agent (please read guidance note 13). If signing on behalf of the applicant, please state in what capacity.**

Signature	
Date	
Capacity	

Contact name (where not previously given) and postal address for correspondence associated with this application (please read guidance note 14) Melrose Group 8 St Mary Street Thornbury			
Post town	Bristol	Postcode	BS35 2AB
Telephone number (if any)	01454 419262 ext 5		
If you would prefer us to correspond with you by e-mail, your e-mail address (optional) licensing@melrosegroupp.co.uk			

#### Notes for Guidance

1. Describe the premises, for example the type of premises, its general situation and layout and any other information which could be relevant to the licensing objectives. Where your application includes off-supplies of alcohol and you intend to provide a place for consumption of these off-supplies, you must include a description of where the place will be and its proximity to the premises.
2. In terms of specific regulated entertainments please note that:
  - Plays: no licence is required for performances between 08:00 and 23.00 on any day, provided that the audience does not exceed 500.
  - Films: no licence is required for 'not-for-profit' film exhibition held in community premises between 08.00 and 23.00 on any day provided that the audience does not exceed 500 and the organiser (a) gets consent to the screening from a person who is responsible for the premises; and (b) ensures that each such screening abides by age classification ratings.
  - Indoor sporting events: no licence is required for performances between 08.00 and 23.00 on any day, provided that the audience does not exceed 1000.
  - Boxing or Wrestling Entertainment: no licence is required for a contest, exhibition or display of Greco-Roman wrestling, or freestyle wrestling between 08.00 and 23.00 on any day, provided that the audience does not exceed 1000. Combined fighting sports – defined as a contest, exhibition or display which combines boxing or wrestling with one or more martial arts – are licensable as a boxing or wrestling entertainment rather than an indoor sporting event.
  - Live music: no licence permission is required for:
    - a performance of unamplified live music between 08.00 and 23.00 on any day, on any premises.
    - a performance of amplified live music between 08.00 and 23.00 on any day on premises authorised to sell alcohol for consumption on those premises, provided that the audience does not exceed 500.

**Consent of individual to being specified as premises supervisor**

I ..... [redacted] ..... (full name of prospective premises supervisor)  
of [redacted]

(home address of prospective premises supervisor)

Date of Birth .. [redacted] ... Place of Birth .. [redacted] .....

Nationality ... British..... Contact tel. number [redacted] ...

hereby confirm that I give my consent to be specified as the designated premises supervisor in relation to the application for

..... Premises Licence DPS ..... (type of application)

By..... Blue Diamond UK Ltd  
..... (name of applicant)

relating to a premises licence ..... NEW..... (number of existing licence, if any)

for ... HARLOW GARDEN, CENTRE, CANES LANE, HASTINGWOOD,  
(name and address of premises of which the application relates) NR HARLOW, CM17 9LD

and any premises licence to be granted or varied in respect of this application made

by ..... as above..... (name of applicant)

concerning the supply of alcohol at

..... as above..... (name and address of premises to which application relates).

I also confirm that I am entitled to work in the United Kingdom and am applying for, intend to apply for or currently hold a personal licence, details of which I set out below.

Personal licence number . [redacted] .....

Personal Licence issuing authority ... Wychavon District Council.....

Signed ... [redacted] .....

Name (please print) ..... Alan Gisbourne..... Date .. 06/08/2019 .....



HARLOD GARAGE CENTRE, CANES LAKE, HASTINGS, CM17 9LD

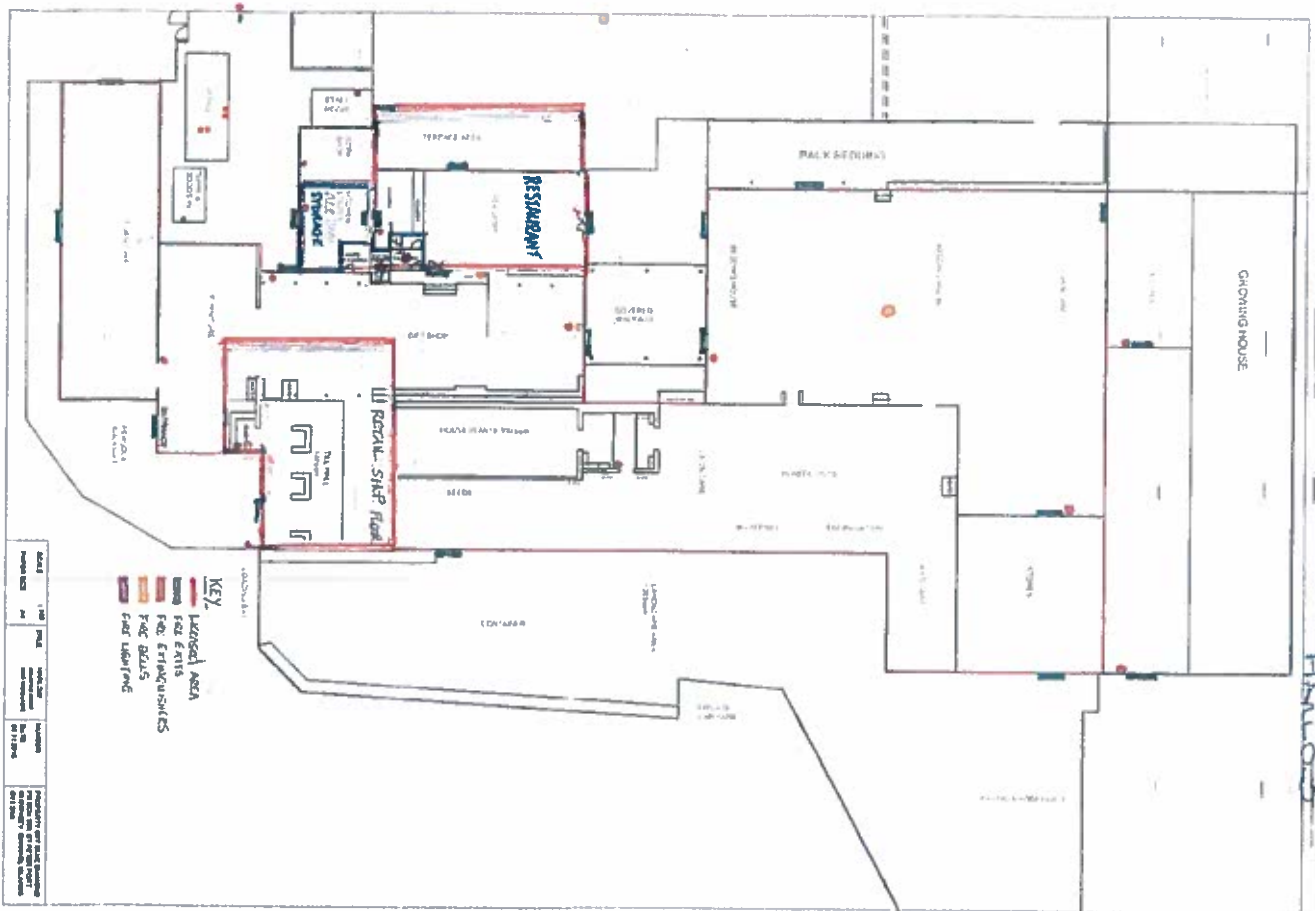

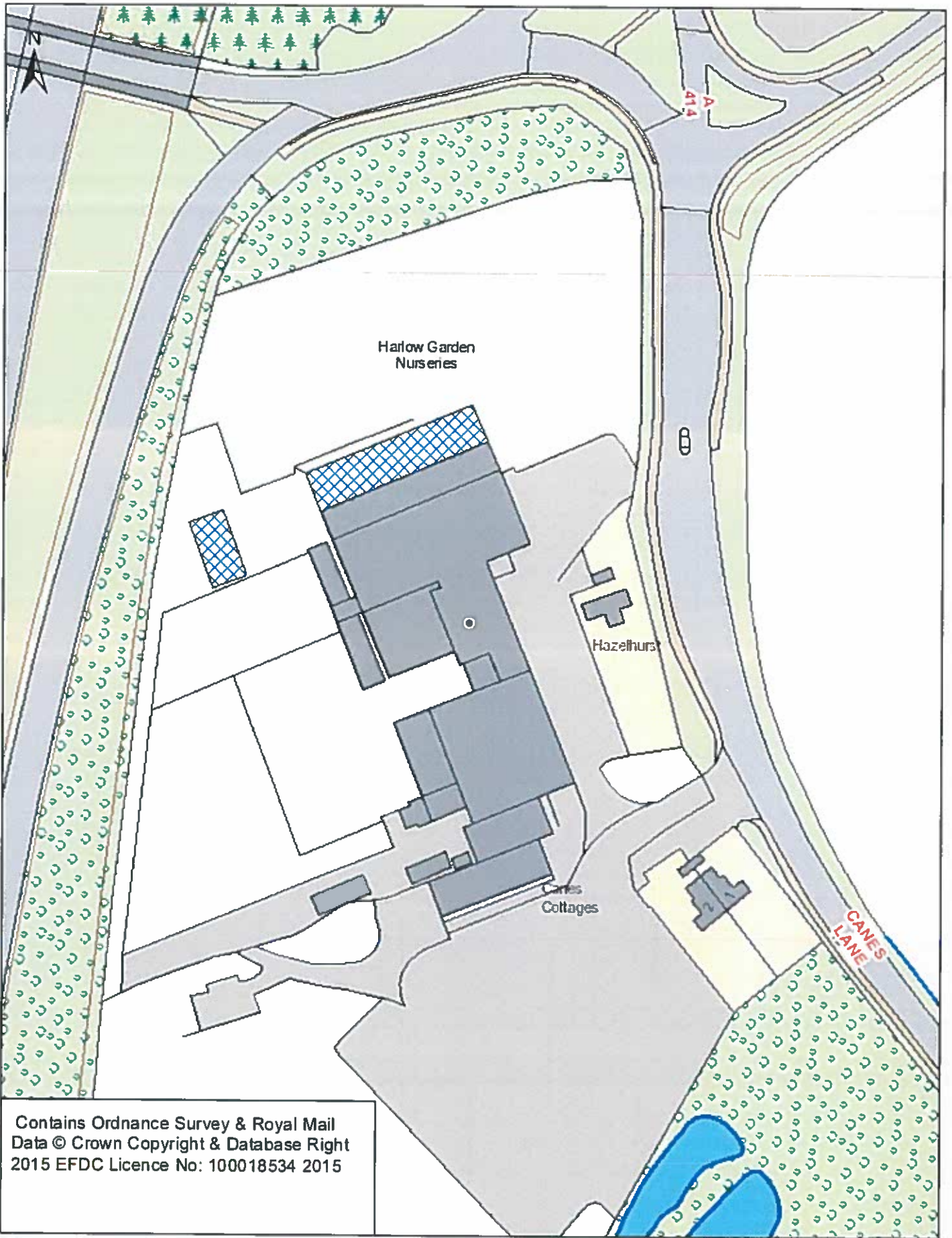

Contains Ordnance Survey & Royal Mail  
 Data © Crown Copyright & Database Right  
 2015 EFDC Licence No: 100018534 2015

**Notice of Application for a New Premises Licence under  
the Licensing Act 2003**

Notice is given that Blue Diamond UK Limited of  
Bambridge Park Garden Centre, Kiln Lane, Eastleigh,  
SO50 6HT have applied to the Licensing office of Epping  
Forest District Council for a Premises Licence in respect of  
Harlow Garden Centre, Canes Lane, Hastingwood, Nr  
Harlow, CM17 9LD

The proposed licence is for the sale of alcohol for  
consumption on and off the premises between 08.30 until  
18.00 hrs Monday to Saturday and 10.00 until 16.30 hrs  
Sundays, opening hours of the same, all as specified in  
the application.

The register of licensed premises is maintained at the  
Licensing Office of Epping Forest District Council, Civic  
Offices, High Street, Epping, Essex, CM16 4BZ.  
Applications for premises licences may be inspected at  
this office during office hours. Anyone wishing to oppose  
this application must give written notice to the Licensing  
Office by 4<sup>th</sup> September 2019.

It is an offence knowingly or recklessly to make a false  
statement in connection with an application which could  
lead to a fine on summary conviction (maximum £5000)

ONLY 70p

HARLOW

# Guardian

## PAMPERED POOCHES AND FABULOUS FELINES

We're searching for the best pet groomers around  
**NOMINATE YOUR FAVOURITE INSIDE**

Trusted news read by 57,259 people every week

Thursday, August 15, 2019

### Probe into claim man was 'fired after cancer diagnosis'

£100k deal to keep on



August 15, 2019

#### Announcements - Public Notices

**TOWN AND COUNTRY PLANNING ACT 1990  
PLANNING (LISTED BUILDINGS AND CONSERVATION AREAS) ACT 1990  
Planning (Listed Buildings and Conservation Areas) Regulations 1990  
Town and Country Planning  
(Development Plans and Consultation) Directions 1992**

#### PUBLIC NOTICE OF APPLICATIONS

The following applications have been received by Harlow District Council. These applications and others received can be inspected at Harlow Council Planning Services, Civic Centre, The Water Gardens, Harlow, Essex, CM20 1WG on Monday - Friday, 9am - 4:45pm. If you are unable to view the plans during these times, please telephone Planning Services on (0) 279 448856 where a suitable appointment can be made with the relevant case officer.

Anyone who wishes to make representations about these applications should write to the Council at the above address within 21 days of the date of this notice.

**Application No:** HW/FUL/19/00298 **Ward:** Little Parndon - Here Street  
**Application Type:** Full Application  
**Location:** Harlow Stadium Stadium Way Harlow Essex  
**Proposal:** Demolition of existing kennels, and construction of a new part one, part three storey building incorporating replacement kennels to accommodate an increased number of greyhounds, offices and overnight accommodation for staff.  
**Reason for Advert:** Local Public Interest



#### Notice of Application for a New Premises Licence under the Licensing Act 2003

Notice is given that Blue Diamond UK Limited of Brambridge Park Garden Centre, Kiln Lane, Eastleigh, SO50 6HT have applied to the Licensing Office of Epping Forest District Council for a Premises Licence in respect of Harlow Garden Centre, Canes Lane, Hastingwood, Nr Harlow, CM17 9LD. The proposed licence is for the sale of alcohol for consumption on and off the premises between 08.30 until 18.00 hrs Monday to Saturday and 10.00 until 18.30 hrs Sundays, opening hours of the same, all as specified in the application. The register of licensed premises is maintained at the Licensing Office of Epping Forest District Council, Civic Offices, High Street, Epping, Essex, CM16 4BZ. Applications for premises licences may be inspected at this office during office hours. Anyone wishing to oppose this application must give written notice to the Licensing Office by 4th September, 2019. It is an offence knowingly or recklessly to make a false statement in connection with an application which could lead to a fine on summary conviction (maximum £5000)

#### Public Notices

**LELAN LOCKYER (Deceased)**  
Pursuant to the Trustee Act 1925 any persons having a claim against or an interest in the Estate of the above named (late of 25) Fowell Court, Prospect Hill, London E17 3EL, who died on 07/02/2019, are required to send written particulars thereof to the undersigned on or before 23/10/2019, after which date the Estate will be distributed having regard only to the claims and interests of which they have had notice.  
Fellowes Solicitors LLP, 21 Church Hill, Welhamstown, London E17 3AD.  
Ref: MSA/ed/yer

### IF YOU'RE A PARTY PLANNER WE CAN HELP YOUR BUSINESS TAKE OFF

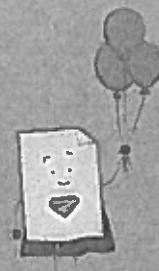

**ZOOM-IN**  
WHATEVER YOU DO  
CALL 0845 1999 830 OR VISIT  
ZOOMINLEAFLETS.CO.UK

### We can reach up to...

**35%**  
of residents reached across East London & West Essex.\*  
\*Source: Telmar Nov 2018



**Guardian**  
To discuss your requirements:  
**020 8884 7420**  
sales@localiq.co.uk  
eppingforestguardian.co.uk  
guardian-series.co.uk

LOCALIQ

## Debbie Houghton

---

**From:** Susan De Luca <Clerk@northweald-pc.gov.uk>  
**Sent:** 04 September 2019 15:04  
**To:** Debbie Houghton  
**Subject:** RE: Application for a New Premises Licence - Harlow Garden Centre, Canes Lane, Hastingwood, CM17 9LD

**CAUTION: This Message originated outside of Epping Forest District Council. Do not click links or open attachments unless you recognise the sender and know the contents is safe.**

---

Good Afternoon Debbie

This is to confirm that the Parish Council Objects to the Alcohol Licence for Harlow Garden Centre.

This is due to Members concerns regarding Public Safety & Public Nuisance.

Kind Regards

Susan De Luca

Clerk to the Council

---

**From:** Debbie Houghton <dhoughton@eppingforestdc.gov.uk>  
**Sent:** 04 September 2019 14:52  
**To:** Susan De Luca <Clerk@northweald-pc.gov.uk>  
**Subject:** RE: Application for a New Premises Licence - Harlow Garden Centre, Canes Lane, Hastingwood, CM17 9LD

Thank you 😊

*Miss Debbie Houghton  
Licensing Officer  
Licensing Team,  
Commercial and Regulatory Directorate  
Tel: 01992 564336  
E-mail: [dhoughton@eppingforestdc.gov.uk](mailto:dhoughton@eppingforestdc.gov.uk)*

**From:** Susan De Luca [<mailto:Clerk@northweald-pc.gov.uk>]  
**Sent:** 04 September 2019 14:47  
**To:** Debbie Houghton  
**Subject:** RE: Application for a New Premises Licence - Harlow Garden Centre, Canes Lane, Hastingwood, CM17 9LD

**CAUTION: This Message originated outside of Epping Forest District Council. Do not click links or open attachments unless you recognise the sender and know the contents is safe.**

---

Yes I haven't forgotten doing it now – got tied up this morning with Dog Bins  
Sue

---

**From:** Debbie Houghton <[dhoughton@eppingforestdc.gov.uk](mailto:dhoughton@eppingforestdc.gov.uk)>  
**Sent:** 04 September 2019 14:44  
**To:** Susan De Luca <[Clerk@northweald-pc.gov.uk](mailto:Clerk@northweald-pc.gov.uk)>  
**Subject:** RE: Application for a New Premises Licence - Harlow Garden Centre, Canes Lane, Hastingwood, CM17 9LD

Good afternoon Susan,

I have been forwarded your email that went to Denise, after speaking with you this morning I am still waiting for your representation to be sent to me with the correct wording, is there a chance that I might get this before 16.00 as I will be leaving then and I have a report for committee to do,

Many thanks  
Debbie

**Miss Debbie Houghton**  
**Licensing Officer**  
**Licensing Team,**  
**Commercial and Regulatory Directorate**  
**Tel: 01992 564336**  
**E-mail: [dhoughton@eppingforestdc.gov.uk](mailto:dhoughton@eppingforestdc.gov.uk)**

**From:** Susan De Luca [<mailto:Clerk@northweald-pc.gov.uk>]  
**Sent:** 04 September 2019 09:44  
**To:** Debbie Houghton  
**Subject:** Fwd: Application for a New Premises Licence - Harlow Garden Centre, Canes Lane, Hastingwood, CM17 9LD

**CAUTION:** This Message originated outside of Epping Forest District Council. Do not click links or open attachments unless you recognise the sender and know the contents is safe.

---

Sent from my iPad

Begin forwarded message:

**From:** Susan De Luca <[Clerk@northweald-pc.gov.uk](mailto:Clerk@northweald-pc.gov.uk)>  
**Date:** 2 September 2019 at 23:55:38 BST  
**To:** Denise Bastick <[dbastick@eppingforestdc.gov.uk](mailto:dbastick@eppingforestdc.gov.uk)>  
**Subject:** Re: Application for a New Premises Licence - Harlow Garden Centre, Canes Lane, Hastingwood, CM17 9LD

Hello Denise

I wish to advise that `members OBJECTED to this licence as they felt a Garden was not an appropriate place for alcohol to be sold.

Kind Regards  
Susan Deluca  
Clerk to the Council

Sent from my iPad

On 8 Aug 2019, at 10:32, Denise Bastick <[dbastick@eppingforestdc.gov.uk](mailto:dbastick@eppingforestdc.gov.uk)> wrote:

Good Morning

Please find attached a new premises licence application for the above premises. The application is for the sale of alcohol, both on and off the premises.

**Hours Open to the Public**

Monday to Saturday 08:30 to 18:00

Sunday 10:00 to 16:30

**Supply of Alcohol**

Monday to Saturday 08:30 to 18:00

Sunday 10:00 to 16:30

both on and off the premises

The start date of the consultation is **8<sup>th</sup> August 2019**, end of consultation will be **4<sup>th</sup> September 2019**. Please let us have any comments or objections by then. The Officer dealing with this application will be Debbie Houghton.

**N.B. This is an unredacted copy and not for public consumption in this format, this will be available on the website shortly.**

Kind regards.

Denise Bastick  
Licensing Compliance Officer  
Commercial and Regulatory Service Directorate  
[dbastick@eppingforestdc.gov.uk](mailto:dbastick@eppingforestdc.gov.uk)  
Tel: 01992 564334  
**Working hours Wednesday – Friday**

Please contact Mrs Handan Ibrahim, Licensing Compliance Officer  
[hibrahim@eppingforestdc.gov.uk](mailto:hibrahim@eppingforestdc.gov.uk) Tel: 01992 564153  
**Monday – Wednesday**



**DISCLAIMER**

This email is for the use of the intended recipients only. Any opinion or advice it contains is that of the sender and does not bind the authority in any way. If you have received it in error, please notify the sender immediately and then delete the message. If you are not the intended recipient you must not use, disclose, copy or distribute this email. We have taken precautions to minimise the risk of transmitting software viruses, but we advise that you carry out your own virus checks on an attachment to this message. We cannot accept liability for any loss or damage caused by software viruses.

Internet email is not a secure communication medium, and we advise that you observe this lack of security when emailing us.

Epping Forest District Council  
[Postmaster@Eppingforestdc.gov.uk](mailto:Postmaster@Eppingforestdc.gov.uk)

<Harlow Garden Centre new premises licence application.pdf>

<Harlow Garden Centre DPS Alan Gisbourne.pdf>

<Harlow Garden Centre plan.pdf>

## Harlow Garden Centre – Conditions Sought

1. The premises will have installed and maintained a closed circuit television surveillance (CCTV) system which at all times complies with the below requirements:
  - i. CCTV will be provided in the form a recordable system, capable of providing pictures of evidential quality in all lighting conditions particularly facial recognition;
  - ii. CCTV cameras will cover all public areas including all entrances and exits and all areas where the sale of alcohol takes place;
  - iii. Equipment will be maintained in good working order, be correctly time and date stamped, recordings must be kept in good working order and kept for a minimum period of 31 days;
  - iv. At all times, whilst the premises is open for licensable activities, there are members of staff able to immediately provide viewable copies of recordings to the police or licensing authority staff upon reasonable request;
  - v. The recording equipment and data storage devices will be kept in a secure environment and fitted with security functions (such as passwords) to prevent recordings being tampered with;
  - vi. An operational daily log report will be maintained endorsed by signature, indicating the system has been checked and is compliant: in the event of any failure this will be recorded immediately.
2. Signs must be displayed at all entrances advising customers that CCTV is operating at the premises and will be a minimum size of 200x148mm and clearly legible at all times when the premises conducts licensable activities.
3. No alcohol may be supplied by an individual unless that individual has the written consent of the Designated Premises Supervisor or other employed Personal Licence Holder. A written record of this consent must be retained on the premises at all times when such an individual supplies or proposes to supply alcohol and be made available immediately upon reasonable request of the police or licensing authority.
4. The sale of alcohol for consumption **ON** the premises must only be to customers seated at a table and ancillary to a substantial table meal.
5. In addition to water, other non-alcoholic beverages will be available at all times whilst alcohol sale or supply takes place.
6. A Challenge 25 scheme will be operated, whereby any person who appears to be under the age of 25 years of age is required to produce on request an item which meets the mandatory age verification requirement **and** is either a:
  - Proof of age card bearing the PASS Hologram;
  - Photocard driving licence;
  - Passport; or
  - Ministry of Defence Identity Card.
7. The premises will clearly display signs advising customers that a 'Challenge 25' policy is in force.



## Debbie Houghton

---

**From:** Licensing Epping and Brentwood  
<licensing.epping.and.brentwood@essex.police.uk>  
**Sent:** 03 September 2019 12:34  
**To:** Licensing; Licensing Epping and Brentwood  
**Cc:** Licensing  
**Subject:** RE: Harlow Garden Centre - Application for Premises Licence  
**Attachments:** Harlow Garden Centre - Conditions Sought.docx

**CAUTION: This Message originated outside of Epping Forest District Council. Do not click links or open attachments unless you recognise the sender and know the contents is safe.**

---

Good afternoon; and thank you for your response. Essex Police are happy to negotiate and agree the amendment to the wording of condition 4.

Mrs Houghton – Please accept this email as an agreed position. Essex Police make no formal representations to the application.

Kind regards,

Peter



**Peter Jones (7706) MIOL MBII**  
Licensing Officer – Epping Forest & Harlow  
☎ 01279625405 (Ext: 313604) ☎ 07870909762  
📍 Loughton Police Station, 158 High Road, Loughton, IG104BE

---

**From:** Licensing <Licensing@melrosegroupp.co.uk>  
**Sent:** 03 September 2019 11:48  
**To:** Licensing Epping and Brentwood <licensing.epping.and.brentwood@essex.police.uk>; Licensing <Licensing@melrosegroupp.co.uk>  
**Cc:** EFDC Licensing <licensing@eppingforestdc.gov.uk>  
**Subject:** RE: Harlow Garden Centre - Application for Premises Licence

Good morning Peter

Apologies again for the late response and thank you for being so patient.

Our client has now been in contact with regards to your suggested conditions (attached). I am pleased to confirm we are happy to accept them all, as worded, with just one exception, condition 4 'The sale of alcohol for consumption ON the premises must only be to customers seated at a table and ancillary to a substantial table meal'.

The restaurant will be primarily food driven, family friendly premises, however many customers may only want a light snack, sandwich or indeed nothing to eat at all if accompanying friends or family. Would you be content with the following reworded condition in place of your suggested condition? 'The consumption of alcohol on the premises shall be restricted to customers seated at a table'.

We do hope the above meets with your approval and we can avoid the need for a hearing on this matter?

Many thanks.

Kind Regards.

Karen Pownall

This page is intentionally left blank